

ATTACHMENT 1

STORMWATER/DRAINAGE SYSTEM MAP

TOWN OF CLOUD LAKE PALM BEACH COUNTY, FLORIDA

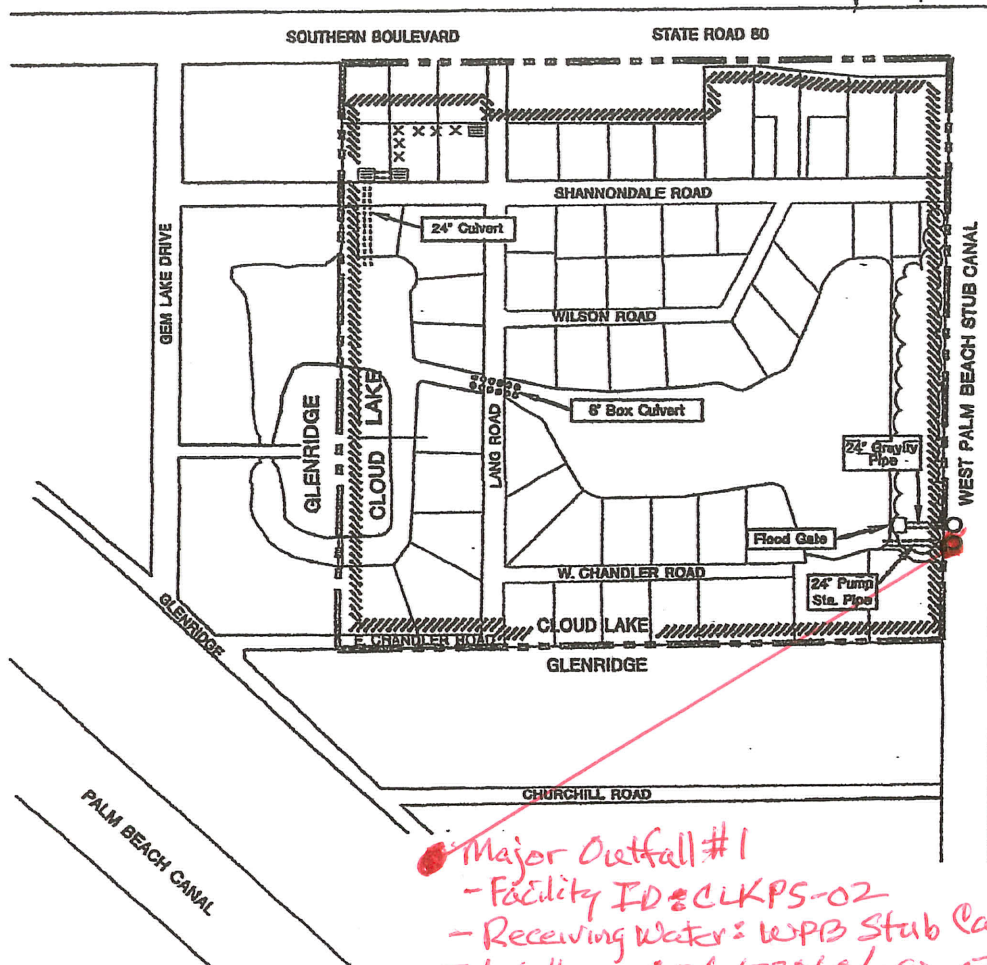

Major Outfall #1
 - Facility ID: CLKPS-02
 - Receiving Water: WPB Stub Canal
 - Lat./Long.: 26.673060/-80.071920

- Notes: 1). Nearly 35 acre, or 96% of the total Town of Cloud Lake municipal land area and all 105 acres contained within the Town of Glen Ridge corporate limits contribute to the overall Town of Cloud Lake Stormwater/Drainage system. Approximately 17 acres at the north end of the Town fronting Southern Blvd. (SR 80) contributes to the FDOT system.
- 2). The Town of Glen Ridge Future Use Map is enclosed to show The municipal boundaries and are contributing to the Cloud Lake Systems.

LEGEND

- //// Town Stormwater/Drainage System Boundary
- Outfall
- Floodgate
- xxx Grass Swale
- ≡ Catch Basin
- == Pipe Drain
- ==== Box Culvert



N.T.S



Attachment . (Continued)

("Town of Cloud Lake Stormwater/Drainage System Map")

- Local Streets**
1. Taylor
 2. Churchill
 3. Chandler
 4. Shamondale
 5. Gem Lake
 6. Windham
 7. Glen Road
 8. Island Road

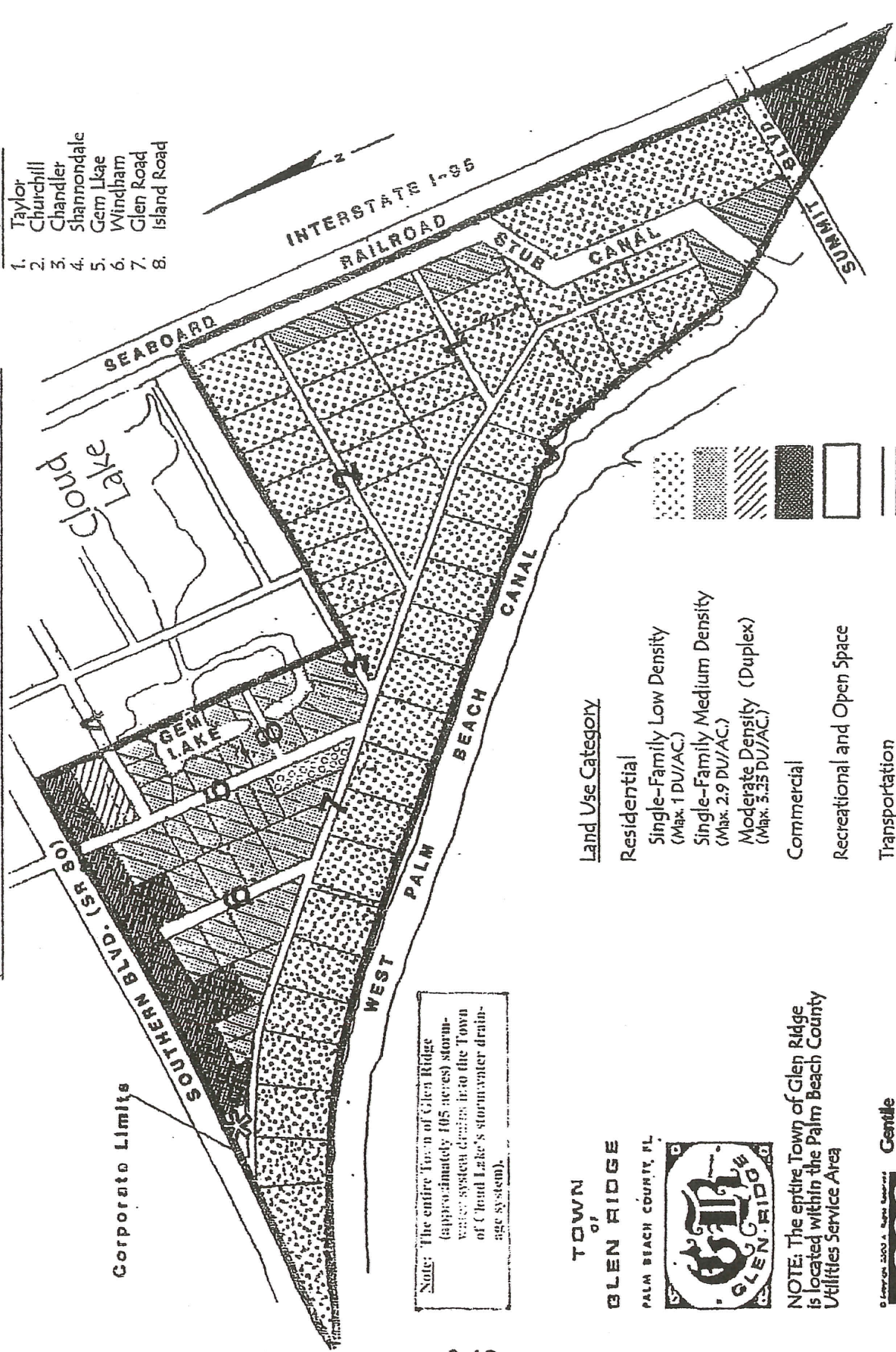

Corporate Limits

Note: The entire Town of Glen Ridge (approximately 105 acres) storm-water system drains into the Town of Cloud Lake's storm-water drainage system.

TOWN OF
BLEN RIDGE
PALM BEACH COUNTY, FL



NOTE: The entire Town of Glen Ridge is located within the Palm Beach County Utilities Service Area



Source: J/LH Associates, 12/08

- Land Use Category**
- Residential
 - Single-Family Low Density (Max. 1 DU/AC)
 - Single-Family Medium Density (Max. 2.9 DU/AC)
 - Moderate Density (Duplex) (Max. 3.35 DU/AC)
 - Commercial
 - Recreational and Open Space
 - Transportation
 - Conservation
 - Public Buildings and Grounds

Future Land Use
FY- 2012/2013 - 2017/2018

Figure 3-4