



# Annual Report Form For Individual NPDES Permits For Municipal Separate Storm Sewer Systems (RULE 62-624.600(2), F.A.C.)

- This Annual Report Form must be completed and submitted to the Department to satisfy the annual reporting requirements established in Rule 62-621.600, F.A.C.
- Submit this fully completed and signed form and any REQUIRED attachments by email to the NPDES Stormwater Program Administrator or to the MS4 coordinator (<http://www.dep.state.fl.us/water/stormwater/npdes/contacts.htm>). Files larger than 10MB may be placed on the FTP site at: [ftp://ftp.dep.state.fl.us/pub/NPDES\\_Stormwater/](ftp://ftp.dep.state.fl.us/pub/NPDES_Stormwater/). After uploading files, email the MS4 coordinator or NPDES Program Administrator to notify them the report is ready for downloading; or by mail to the address in the box at right.
- Refer to the Form Instructions for guidance on completing each section.
- Please print or type information in the appropriate areas below.

**Submit the form and attachments to:**  
 Florida Department of Environmental Protection  
 Mail Station 3585  
 2600 Blair Stone Road  
 Tallahassee, Florida 32399-2400

## SECTION I. BACKGROUND INFORMATION

<b>A.</b>	Permittee Name: Town of Juno Beach		
<b>B.</b>	Permit Name: Palm Beach County MS4		
<b>C.</b>	Permit Number: FLS000018-004		
<b>D.</b>	Annual Report Year: <input checked="" type="checkbox"/> Year 1 <input type="checkbox"/> Year 2 <input type="checkbox"/> Year 3 <input type="checkbox"/> Year 4 <input type="checkbox"/> Year 5 <input type="checkbox"/> Other, specify Year:		
<b>E.</b>	Reporting Time Period (month/year): October / 2016 through October / 2017		
<b>F.</b>	Name of the Responsible Authority: Joseph F. LoBello		
	Title: Town Manager		
	Mailing Address: 340 Ocean Drive		
	City: Juno Beach	Zip Code: 33408	County: Palm Beach
	Telephone Number: 561-626-1122		Fax Number: 561-775-0812
	E-mail Address: jlobello@juno-beach.fl.us		
<b>G.</b>	Name of the Designated Stormwater Management Program Contact (if different from Section I.F above): Anthony R. Meriano		
	Title: Director of Public Works		
	Department: Public Works		
	Mailing Address: 340 Ocean Drive		
	City: Juno Beach	Zip Code: 33408	County: Palm Beach
	Telephone Number: 561-626-1122		Fax Number: 561-775-0812
	E-mail Address: ameriano@juno-beach.fl.us		

## SECTION II. MS4 MAJOR OUTFALL INVENTORY (Not Applicable in Year 1)

<b>A.</b>	Number of outfalls ADDED to the outfall inventory in the current reporting year (insert "0" if none): 0 (Does this number include non-major outfalls? <input type="checkbox"/> Yes <input type="checkbox"/> No <input checked="" type="checkbox"/> Not Applicable)
<b>B.</b>	Number of outfalls REMOVED from the outfall inventory in the current reporting year (insert "0" if none): (Does this number include non-major outfalls? <input type="checkbox"/> Yes <input type="checkbox"/> No <input checked="" type="checkbox"/> Not Applicable)
<b>C.</b>	Is the change in the total number of outfalls due to lands annexed or vacated? <input type="checkbox"/> Yes <input type="checkbox"/> No <input checked="" type="checkbox"/> Not Applicable

**SECTION III. PART V.B. ASSESSMENT PROGRAM**

<b>A.</b>	<p>Provide a brief statement as to the status of water quality monitoring plan implementation. Status may include sampling frequency changes, monitoring location changes, or sampling waiver conditions.</p> <p>Please see the Palm Beach County Joint Annual Report for the monitoring information.</p> <p>Name and date of the approved plan: Current approved plan for the Group Monitoring Plan is September 8, 2016 (with issuance of the Cycle 4 permit). Our newly-developed, individual Assessment Plan was submitted on 9/8/17.</p> <p>Status: The Group Monitoring Report is included in the Cycle 4, Year 1 Joint Annual Report. The newly-developed, individual Assessment Plan is awaiting approval by FDEP.</p>
<b>B.</b>	<p>Provide a brief discussion of the monitoring and loading results to date which includes a summary of the water quality monitoring data and / or stormwater pollutant loading changes from the reporting year.</p> <p>Please refer to the Cycle 4, Year 1 Joint Annual Report for a summary of the Group's water quality monitoring results for the reporting period. Refer to the Cycle 3, Year 6 Joint Annual Report for proposed pollutant loading analysis changes. The best available information on existing pollutant loading estimates is documented in the Cycle 3, Year 3 Joint Annual Report.</p> <p>The newly-developed, individual Assessment Plan is under review by FDEP and will be implemented during Year 2 of the permit cycle. Note that in any future reporting year, the Group's water quality monitoring data for the reporting period may not be available for 4 to 6 months after the reporting period has ended. Consequently, any water quality data from the Group Program that is used as part of an individual permittee's Assessment Plan for the reporting period, will be based on the previous year's data.</p>
<b>C.</b>	<p>Attach a monitoring data summary as required by the permit. An analysis of the data discussing changes in water quality and/or stormwater pollutant loading from previous reporting years.</p> <p>See response for Section III.B., above.</p>

**SECTION IV. FISCAL ANALYSIS**

<b>A.</b>	Total expenditures for the NPDES stormwater management program for the current reporting year: \$77,434.72
<b>B.</b>	Total budget for the NPDES stormwater management program for the subsequent reporting year: \$114,727.79
<b>C.</b>	<p>Did the current reporting year resources decrease from the previous year? Y <input checked="" type="checkbox"/> / N <input type="checkbox"/></p> <p>If program resources decreased, provide a discussion of the impacts on the implementation of the SWMP.</p> <p>Stormwater drain pipe repairs which were not included in this years budget were made during the past reporting period.</p>

**SECTION V. MATERIALS TO BE SUBMITTED WITH THIS ANNUAL REPORT FORM**

Only the following materials are to be submitted to the Department along with this fully completed and signed Annual Report Form (check the appropriate box to indicate whether the item is attached or is not applicable):

Attached	N/A	Required Attachments	Permit Citation	Attachment Number/Title
<input type="checkbox"/>	<input checked="" type="checkbox"/>	Any additional information required to be submitted in this current annual reporting year in accordance with Part III.A of your permit that is not otherwise included in Section VII below.	Part III.A	
<input type="checkbox"/>	<input checked="" type="checkbox"/>	An explanation of why the minimum inspection frequency in Table II.A.1.a. was not met, if applicable.	Part II.A.1	
<input type="checkbox"/>	<input checked="" type="checkbox"/>	A list of the flood control projects that did not include stormwater treatment and an explanation for each of why it did not (if applicable).	Part III.A.4	
<input checked="" type="checkbox"/>	<input checked="" type="checkbox"/>	A monitoring data summary as directed in Section III.C above and in accordance with Rule 62-624.600(2)(c), F.A.C.	Part V.B.3	Refer to joint report
<input checked="" type="checkbox"/>	<input type="checkbox"/>	YEAR 1 ONLY: An inventory of all known major outfalls and a map depicting the location of the major outfalls (hard copy or CD-ROM) in accordance with Rule 62-624.600(2)(a), F.A.C.	Part III.A.1	#1, Storm Drainage System Map
<input type="checkbox"/>	<input checked="" type="checkbox"/>	YEAR 2: A summary review of codes and regulations to reduce the stormwater impact from development.	Part III.A.2	
<input type="checkbox"/>	<input checked="" type="checkbox"/>	Year 3 ONLY: The estimates of pollutant loadings and event mean concentrations for each major outfall or each major watershed in accordance with Rule 62-624.600(2)(b), F.A.C.	Part V.A	
<input type="checkbox"/>	<input checked="" type="checkbox"/>	YEAR 3: Summary of TMDL Monitoring Results (if applicable).	Part VIII.B.2	
<input type="checkbox"/>	<input checked="" type="checkbox"/>	YEAR 3: Bacteria Pollution Control Plan (if applicable).	Part VIII.B.3	
<input type="checkbox"/>	<input checked="" type="checkbox"/>	YEAR 4: A follow-up report on plan implementation of changes to codes and regulations to reduce the stormwater impact from development.	Part III.A.2	
<input type="checkbox"/>	<input checked="" type="checkbox"/>	YEAR 4: A report on any amendments to the applicable legal authority (if applicable).	Part III.A.7.a	
<input type="checkbox"/>	<input checked="" type="checkbox"/>	YEAR 4: Permit re-application information in accordance with Rule 62-624.420(2), F.A.C. <ul style="list-style-type: none"><li>• The monitoring plan (with revisions, if applicable).</li><li>• If the total annual pollutant loadings have not decreased over the past two permit cycles, revisions to the SWMP, as appropriate.</li></ul>	Part V.B.3 Part V.A.3	
<input type="checkbox"/>	<input checked="" type="checkbox"/>	YEAR 4: TMDL Supplemental SWMP (if applicable).	Part VIII.B.3	

**DO NOT SUBMIT ANY OTHER MATERIALS**

(such as records and logs of activities, monitoring raw data, public outreach materials, etc.)

**SECTION VI. CERTIFICATION STATEMENT AND SIGNATURE**

The Responsible Authority listed in Section I.F above must sign the following certification statement, as per Rule 62-620.305, F.A.C:

I certify under penalty of law that this document and all attachments were prepared under my direction or supervision in accordance with a system designed to assure that qualified personnel properly gathered and evaluated the information submitted. Based upon my inquiry of the person or persons who manage the system, or those persons directly responsible for gathering the information, the information submitted is, to the best of my knowledge and belief, true, accurate and complete. I am aware that there are significant penalties for submitting false information, including the possibility of fine and imprisonment for knowing violations.

Name of Responsible Authority (type or print): Joseph F. LoBello

Title: Town Manager

Signature: 

Date: 3/6/2018

SECTION VII. STORMWATER MANAGEMENT PROGRAM (SWMP) SUMMARY TABLE						
A.	B.	C.	D.	E.	F.	
Permit Citation/ SWMP Element	Permit Requirement/Quantifiable SWMP Activity	Number of Activities Performed	Documentation / Record	Entity Performing the Activity	Comments	
Part III.A.1	Structural Controls and Stormwater Collection Systems Operation					
Report the current known inventory.						
Report the number of inspection and maintenance activities conducted for each applicable type of structure included in Table II.A.1.a, and the percentage of the total inventory of each type of structure inspected and maintained.						
<i>Note: Delete structures that are not in your MS4's inventory. The permittee may choose its own unit of measurement for each structural control to be consistent with the unit of measurement in the documentation. Unit options include: miles, linear feet, acres, etc.</i>						
	Type of Structure	Number of Structures	Number of Inspections	Percent Inspected	Number of Maintenance Activities	Percent Maintained
	Exfiltration trench / French drains (lf)	1000	2	100	4	100
	Grass treatment swales (miles)	2	12	100	4	100
	Wet detention systems	1	4	100	2	100
	Major outfalls	1	4	100	1	100
	Weirs or other control structures	1	4	100	1	100
	pipes / culverts (miles)	1.2	4	50	2	25
	Inlets / catch basins / grates	128	256	100	2	100
	Ditches / conveyance swales (miles)	.5	24	100	2	100
	<input type="checkbox"/>					
	<p>If the minimum inspection frequencies set forth in Table II.A.1.a. were not met, provide as an attachment an explanation of why they were not and a description of the actions that will be taken to ensure that they will be met.</p>					
		All Met				

SECTION VII. STORMWATER MANAGEMENT PROGRAM (SWMP) SUMMARY TABLE					
A.	B.	C.	D.	E.	F.
Permit Citation/ SWMP Element	Permit Requirement/Quantifiable SWMP Activity	Number of Activities Performed	Documentation / Record	Entity Performing the Activity	Comments
Part III.A.1 Summary	Provide an evaluation of the Stormwater Management Program according to Part VI.B.2 of the permit.  Strengths: Structural Controls inspected and maintained on regular basis Limitations: None SWMP revisions implemented to address limitations: None Necessary				
Part III.A.2	Areas of New Development and Significant Redevelopment  Report the number of significant development projects, including new and redevelopment, reviewed and approved by the permittee for post-development stormwater considerations.  <div> <div>Number of significant development projects reviewed</div> <div>0</div> </div> <div> <div>Number of significant development projects approved</div> <div>0</div> </div>				
	Provide in the Year 2 Annual Report the summary report of the review activity. Provide in the Year 4 Annual Report the follow-up report on plan implementation.  <div> <div>Year 2 ONLY: Attach the summary report of the review activity</div> <div><input type="checkbox"/></div> </div> <div> <div>Year 4 ONLY: Attach the follow-up report on plan implementation</div> <div><input type="checkbox"/></div> </div>				
Part III.A.2 Summary	Provide an evaluation of the Stormwater Management Program according to Part VI.B.2 of the permit.  Strengths: N/A, No significant development this reporting period Limitations: None SWMP revisions implemented to address limitations: N/A				
Part III.A.3	Roadways  Report on the litter control program, including the frequency of litter collection, an estimate of the total number of road miles cleaned or amount of area covered by the activities, and an estimate of the quantity of litter collected.  <i>Note: If the permittee does not contract activities, delete CONTRACTOR activities.</i>				
	<div> <div>PERMITTEE Litter Control: Frequency of litter collection</div> <div>2x</div> </div> <div> <div>PERMITTEE Litter Control: Estimated amount of area maintained (lf)</div> <div>1800</div> </div> <div> <div>PERMITTEE Litter Control: Estimated amount of litter collected (cy)</div> <div>16</div> </div> <div> <div>CONTRACTOR Litter Control: Frequency of litter collection</div> <div>0</div> </div> <div> <div>CONTRACTOR Litter Control: Estimated amount of area maintained (lf)</div> <div>0</div> </div> <div> <div>CONTRACTOR Litter Control: Estimated amount of litter collected (cy)</div> <div>0</div> </div>	<div> <div>Sign in sheets</div> <div>Route Slips</div> <div>Weight Slips</div> </div> <div> <div>Volunteers/DPW</div> <div>Volunteers/DPW</div> <div>Solid Waste Authority</div> </div> <div> <div>DPW Records</div> <div>DPW Records</div> <div>DPW Records</div> </div> <div> <div>N/A</div> <div>N/A</div> <div>N/A</div> </div>			
	OPTIONAL: If an Adopt-A-Road or similar program is implemented, report the total number of road miles cleaned and an estimate of the quantity of litter collected. If you do not participate in an Adopt-A-Road program, report "0".  <div> <div>Trash Pick-up Events: Total miles cleaned</div> <div>2.6</div> </div> <div> <div>Trash Pick-up Events: Estimated amount of litter collected (cy)</div> <div>2.0</div> </div> <div> <div>Adopt-A-Road: Total miles cleaned</div> <div>0.5</div> </div> <div> <div>Adopt-A-Road: Estimated amount of litter collected (cy)</div> <div>1</div> </div>	<div> <div>Sign in sheets</div> <div>Weight Slips</div> <div>Signage</div> <div>Weight Slips</div> </div> <div> <div>Volunteers/DPW</div> <div>Volunteers/DPW</div> <div>Private Company</div> <div>Private Company</div> </div> <div> <div>DPW Records</div> <div>DPW Records</div> <div>None</div> <div>None</div> </div>			

SECTION VII. STORMWATER MANAGEMENT PROGRAM (SWMP) SUMMARY TABLE					
A.	B.	C.	D.	E.	F.
Permit Citation/ SWMP Element	Permit Requirement/Quantifiable SWMP Activity	Number of Activities Performed	Documentation / Record	Entity Performing the Activity	Comments
	Report on the street sweeping program, including the frequency of the sweeping, total miles swept, an estimate of the quantity of sweepings collected, and the total nitrogen and total phosphorus loadings that were removed by the collection of sweepings. If no street sweeping program is implemented, provide the explanation of why not in column F.				
	<p><b>Frequency of street sweeping</b></p> <p>4x annual</p> <p>Invoice</p> <p>Facilities Prosweep</p> <p>DPW Records</p>				
	<p><b>Estimated quantity of sweeping material collected (cy)</b></p> <p>16.0</p> <p>Invoice</p> <p>"</p> <p>DPW Records</p>				
	<p><b>Total phosphorous loadings removed (pounds)</b></p> <p>15.7</p> <p>Invoice</p> <p>"</p> <p>DPW Records</p>				
	<p><b>Total nitrogen loadings removed (pounds)</b></p> <p>20</p> <p>FSA Worksheet</p> <p>Public Works</p> <p>FSA Calculator</p>				
	<p><b>Total nitrogen loadings removed (pounds)</b></p> <p>13</p> <p>FSA Worksheet</p> <p>Public Works</p> <p>FSA Calculator</p>				
	Report the equipment yards and maintenances shops that support road maintenance activities, and the number of inspections conducted for each facility.				
	<b>Name of Facility</b>	<b>Number of Inspections</b>			
	<b>DPW Maintenance Facility</b>	2	Inspection Form	DPW Staff	2x Annually
	Provide an evaluation of the Stormwater Management Program according to Part VI.B.2 of the permit.				
<b>Part III.A.3 Summary</b>	<p><b>Strengths:</b> The Litter Control Programs continues to help with the reduction of pollutants being discharged.</p> <p><b>Limitations:</b> None</p> <p><b>SWMP revisions implemented to address limitations:</b> N/A</p>				
<b>Part III.A.4</b>	<b>Flood Control Projects</b>				
	Report the total number of flood control projects that were constructed by the permittee during the reporting period and the number of those projects that did NOT include stormwater treatment. The permittee shall provide a list of the projects where stormwater treatment was not included with an explanation for each of why it was not.				
	Report on any stormwater retrofit planning activities and the associated implementation of retrofitting projects to reduce stormwater pollutant loads from existing drainage systems that do not have treatment BMPs.				
	<p><b>Flood control projects completed during the reporting period</b></p> <p>0</p> <p>N/A</p>				
	<p><b>Flood control projects completed that did not include stormwater treatment</b></p> <p>0</p> <p>N/A</p>				
	<p><b>Stormwater retrofit projects planned/under construction</b></p> <p>0</p> <p>N/A</p>				
	<p><b>Stormwater retrofit projects completed</b></p> <p>0</p> <p>N/A</p>				
	If there were projects that did not include stormwater treatment, provide as an attachment a list of the projects and an explanation for each of why it did not.	<input type="checkbox"/>			
	Provide an evaluation of the Stormwater Management Program according to Part VI.B.2 of the permit.				
<b>Part III.A.4 Summary</b>	<p><b>Strengths:</b> No areas identified as needing improvement during inspection and maintenance of Town Systems</p> <p><b>Limitations:</b> N/A</p> <p><b>SWMP revisions implemented to address limitations:</b> None</p>				

SECTION VII. STORMWATER MANAGEMENT PROGRAM (SWMP) SUMMARY TABLE					
A.	B.	C.	D.	E.	F.
Permit Citation/ SWMP Element	Permit Requirement/Quantifiable SWMP Activity	Number of Activities Performed	Documentation / Record	Entity Performing the Activity	Comments
Part III.A.5	Municipal Waste Treatment, Storage, and Disposal Facilities Not Covered by an NPDES Stormwater Permit				
	Report the applicable facilities and the number of the inspections conducted for each facility.				
	Name of Facility	Number of Inspections			
	N/A				
Part III.A.5 Summary	Provide an evaluation of the Stormwater Management Program according to Part VI.B.2 of the permit.				
	Strengths: N/A				
	Limitations: N/A				
	SWMP revisions implemented to address limitations: N/A				
Part III.A.6	Pesticides, Herbicides, and Fertilizer Application				
	Report the number of permittee personnel applicators and contracted commercial applicators of pesticides and herbicides who are FDACS certified / licensed.				
	Report the number of permittee personnel who have been trained through the Green Industry BMP Program and the number of contracted commercial applicators of fertilizer who are FDACS certified / licensed.				
	PERSONNEL: FDACS public applicators of pesticides/herbicides CONTRACTORS: FDACS commercial applicators of pesticides/ herbicides	4	FDACS License	FDACS	DPW Staff Beach Environmental
	PERSONNEL: Green Industry BMP Program training completed CONTRACTORS: FDACS certified / licensed applicators of fertilizer	2	FDACS License	FDACS	N/A
	PERSONNEL: Green Industry BMP Program training completed CONTRACTORS: FDACS certified / licensed applicators of fertilizer	0	N/A	N/A	N/A
	PERSONNEL: Green Industry BMP Program training completed CONTRACTORS: FDACS certified / licensed applicators of fertilizer	2	FDACS License	FDACS	Terracon Services
	Provide a copy of the adopted ordinance with the Year 2 Annual Report. If this provision is not applicable because the permittee is not within the watershed of a nutrient-impaired water body, indicate that in Column F.				
	Year 2 ONLY: Attach copy of adopted Florida-friendly ordinance	<input type="checkbox"/>			
	Report on the public education and outreach activities that are performed or sponsored by the permittee within the permittee's jurisdiction to encourage citizens to reduce their use of pesticides, herbicides and fertilizers including the type and number of activities conducted, the type and number of materials distributed, and the number of Web site visits (if applicable).				
	Public Education and Outreach Program				
	Brochures/Flyers/Fact sheets distributed	6000	Mailing Lists	Town Clerk	Town Center
	Neighborhood presentations: Number conducted	2	HOA Meeting	DPW	Town Center
	Neighborhood presentations: Number of participants	25-30	HOA Meeting	DPW	Town Center
	Newspapers & newsletters: Number of articles/notices published	2	Mailing Lists	Town Clerk	Newsletter
	Newsletters: Number of newsletters distributed	6000	Mailing Lists	Town Clerk	2X Annual
	Public displays (e.g., kiosks, storyboards, posters, etc.)	1	Pamphlets	Town Clerk	Town Center

**SECTION VII. STORMWATER MANAGEMENT PROGRAM (SWMP) SUMMARY TABLE**

A.	B.	C.	D.	E.	F.
Permit Citation/ SWMP Element	Permit Requirement/Quantifiable SWMP Activity	Number of Activities Performed	Documentation / Record	Entity Performing the Activity	Comments
	Number of visitors to stormwater-related pages	1200	Town Website	Town Clerk	
	Provide an evaluation of the Stormwater Management Program according to Part VI.B.2 of the permit.				
Part III.A.6 Summary	Strengths: Continue to ensure proper training and display of educational materials				
	Limitations: None				
	SWMP revisions implemented to address limitations: n/a				
Part III.A.7.a	Illicit Discharges and Improper Disposal — Inspections, Ordinances, and Enforcement Measures				
	Report amendments in Year 4.				
	Year 4 ONLY: Attach a report on amendments to applicable legal authority <input type="checkbox"/>				
Part III.A.7.c	Illicit Discharges and Improper Disposal — Investigation of Suspected Illicit Discharges and/or Improper Disposal				
	Report on the proactive inspection program, including the number of inspections conducted by the permittee, the number of illicit activities found, and the number and type of enforcement actions taken.				
	Proactive inspections for suspected illicit discharges	15	Code Inspection Reports	Code Inspection DPW	Routine Inspection
	Illicit discharges found during a proactive inspection	8	Code Inspection Reports	Code Inspection	Inspection Report
	NOV/WVL/citation/fines issued for illicit discharges found during proactive inspection	3	Code Inspection Reports	Code Inspection	Notice of Warning
	Report on the reactive investigation program as it relates to responding to reports of suspected illicit discharges, including the number of reports received, the number of investigations conducted, the number of illicit activities found, and the number and type of enforcement actions taken.				
	Reports of suspected illicit discharges received	8	Code Inspection Reports	Code Inspection	Inspection Report
	Reactive investigations of reports of suspected illicit discharges etc.	8	Code Inspection Reports	Code Inspection	Inspection Report
	Illicit discharges etc. found during reactive investigation	3	Code Inspection Reports	Code Inspection	Notice of Violation
	NOV/WVL/citation/fines issued for illicit discharges etc. found during reactive investigation	3	Code Inspection Reports	Code Inspection	Notice of Violation
	Report the type of training activities, and the number of permittee personnel and contractors trained (both in-house and outside training) within the reporting year.				
	Personnel trained	2	2	Sign-in Sheet	NPBCID
	Contractors trained	1	1	Sign-in Sheet	NPBCID



SECTION VII. STORMWATER MANAGEMENT PROGRAM (SWMP) SUMMARY TABLE					
A.	B.	C.	D.	E.	F.
Permit Citation/ SWMP Element	Permit Requirement/Quantifiable SWMP Activity	Number of Activities Performed	Documentation / Record	Entity Performing the Activity	Comments
Part III.A.7.d	<b>Illicit Discharges and Improper Disposal — Spill Prevention and Response</b>  Report on the spill prevention and response activities, including the number of spills addressed.  <b>Hazardous and non-hazardous material spills responded to</b>  Report the type of training activities, and the number of permittee personnel and contractors trained (both in-house and outside training) within the reporting year.	0	0	N/A	N/A
	<b>Personnel trained</b>	2	2	Sign-in Sheet	NPBCID
	<b>Contractors trained</b>	1	1	Sign-in Sheet	NPBCID
Part III.A.7.e	<b>Illicit Discharges and Improper Disposal — Public Reporting</b>  Report on the public education and outreach activities that are performed or sponsored by the permittee within the permittee's jurisdiction to encourage the public reporting of suspected illicit discharges and improper disposal of materials, including the type and number of activities conducted, the type and number of materials distributed, and the number of Web site visits (if applicable).				
	<b>Public Education and Outreach Program</b>  The public outreach and education plan is carried out as a joint effort by the Palm Beach County Co-permittees. Please see the Palm Beach County Joint Annual Report for the public education and outreach information.	6000	Mailing Lists	Town Clerk	
	<b>Brochures/Flyers/Fact sheets distributed</b>	2	HOA Meeting	DPW	Town Center
	<b>Neighborhood presentations: Number conducted</b>	30	HOA Meeting	DPW	Town Center
	<b>Neighborhood presentations: Number of participants</b>	2	Mailing Lists	Town Clerk	Newsletter
	<b>Newspapers &amp; newsletters: Number of articles/notices published</b>	6000	Mailing Lists	Town Clerk	2X Annual
	<b>Newsletters: Number of newsletters distributed</b>	1	Pamphlets	Town Clerk	Town Center
	<b>Public displays (e.g., kiosks, storyboards, posters, etc.)</b>	970	Town Website	Town Clerk	Website
Part III.A.7.f	<b>Illicit Discharges and Improper Disposal — Oils, Toxics, and Household Hazardous Waste Control</b>  Report on the public education and outreach activities that are performed or sponsored by the permittee within the permittee's jurisdiction to encourage the proper use and disposal of oils, toxics, and household hazardous waste, including the type and number of activities conducted, the type and number of materials distributed, the amount of waste collected / recycled / properly disposed, and the number of Web site visits (if applicable).				
	<b>Public Education and Outreach Program</b>  The public outreach and education plan is carried out as a joint effort by the Palm Beach County Co-permittees. Please see the Palm Beach County Joint Annual Report for the public education and outreach information.	6000	Mailing Lists	Town Clerk	
	<b>Brochures/Flyers/Fact sheets distributed</b>	2	HOA Meeting	DPW	Town Center
	<b>Neighborhood presentations: Number conducted</b>	30	HOA Meeting	DPW	Town Center
	<b>Neighborhood presentations: Number of participants</b>	2	Mailing Lists	Town Clerk	Newsletter
	<b>Newspapers &amp; newsletters: Number of articles/notices published</b>	6000	Mailing Lists	Town Clerk	2X Annual
	<b>Newsletters: Number of newsletters distributed</b>	1	Pamphlets	Town Clerk	Town Center
	<b>Public displays (e.g., kiosks, storyboards, posters, etc.)</b>	970	Town Website	Town Clerk	Website

**SECTION VII. STORMWATER MANAGEMENT PROGRAM (SWMP) SUMMARY TABLE**

A.	B.	C.	D.	E.	F.
Permit Citation/ SWMP Element	Permit Requirement/Quantifiable SWMP Activity	Number of Activities Performed	Documentation / Record	Entity Performing the Activity	Comments
Part III.A.7.g	<p><b>Illicit Discharges and Improper Disposal — Limitation of Sanitary Sewer Seepage</b></p> <p>Report on the type and number of activities undertaken to reduce or eliminate SSOs and inflow / infiltration, the number of SSOs or inflow / infiltration incidents found and the number resolved, and the name of the owner of the sanitary sewer system within the permittee's jurisdiction. Report only the SSOs and inflow / infiltration incidents into the MS4.</p>				
	<p><b>Owner of the sanitary sewer system</b></p> <p>Activity to reduce/eliminate SSOs and I&amp;I: (TV inspections)</p> <p>Activity to reduce/eliminate SSOs and I&amp;I: (Lining gravity mains)</p>	<p>Seacoast Utility Authority (SUA)/ Loxahatchee River District (LRD)</p> <p>0</p> <p>0</p>	<p>n/a</p> <p>n/a</p>	<p>SUA/LRD</p> <p>SUA/LRD</p>	
	SSO incidents discovered	0/27	On file at utility provider office	SUA/LRD	Quantity is for entire LRD, records not separated by municipality
	SSO incidents resolved	0/27	On file at utility provider office	SUA/LRD	"
	Inflow / infiltration incidents discovered	0/0	n/a	SUA/LRD	
	Inflow / infiltration incidents resolved	0/0	n/a	SUA/LRD	
Part III.A.7 Summary	For activities required by Part III.A.7: Provide an evaluation of the Stormwater Management Program according to Part VI.B.2 of the permit.				
	Strengths: Continued training				
	Limitations: N/A				
	SWMP Revisions implemented to address limitations: None needed				
Part III.A.8.a	<b>Industrial and High-Risk Runoff — Identification of Priorities and Procedures for Inspections</b>				
	Report on the high-risk facilities inventory, including the type and total number of high risk facilities and the number of facilities newly added each year. Report on the high-risk facilities inspection program, including the number of inspections conducted and the number and type of enforcement actions taken.				
	Type of Facility	Number of Facilities	Number of Inspections	Enforcement Actions	
	Operating municipal landfills	0	N/A	N/A	
	Hazardous waste treatment, storage, disposal and recovery (HWTSDR) facilities	1	2	N/A	DPW
	EPCRA Title III, Section 313 facilities (TRI)	0	0	N/A	No EPCRA Title III
	Facilities determined as high risk by the permittee	0	0	N/A	

## SECTION VII. STORMWATER MANAGEMENT PROGRAM (SWMP) SUMMARY TABLE

A.	B.	C.	D.	E.	F.
Permit Citation/ SWMP Element	Permit Requirement/Quantifiable SWMP Activity	Number of Activities Performed	Documentation / Record	Entity Performing the Activity	Comments
Part III.A.8.b	Industrial and High-Risk Runoff — Monitoring for High Risk Industries				
	Report the number of high risk facilities sampled.				
	High risk facilities sampled	0	N/A		No high risk sites in Town
Part III.A.8 Summary	Provide an evaluation of the Stormwater Management Program according to Part VI.B.2 of the permit.				
	Strengths: Routine inspections increase chances of eliminating pollutants				
	Limitations: N/A				
	SWMP revisions implemented to address limitations: None Needed				
Part III.A.9.a	Construction Site Runoff — Site Planning and Non-Structural and Structural Best Management Practices				
	Report the number of permittee and private pre-construction site plans reviewed for stormwater, erosion, and sedimentation controls, and the number approved.				
	PERMITTEE SITES: Construction site plans reviewed	2	Comment Letter	Consultant	
	PERMITTEE SITES: Construction site plans approved	1	Approval Letter	Consultant	
	PRIVATE SITES: Construction site plans reviewed	8	Comment Letter	Consultant	
	PRIVATE SITES: Construction site plans approved	5	Approval Letter	Consultant	
	Report the number of development permit applicants notified of the ERP and CGP, and the number of applicants who confirmed ERP and CGP coverage.				
	Notified of ERP stormwater permit requirements	5	Approval Letter	Consultant	
	Confirmed ERP coverage	5	Approval Letter	Consultant	
	Notified of CGP stormwater permit requirements	5	Approval Letter	Consultant	
	Confirmed CGP coverage	2	Approval Letter	Consultant	
Part III.A.9.b	Construction Site Runoff — Inspection and Enforcement				
	Report on the inspection program for privately-operated and permittee-operated construction sites, including the number of active construction sites during the reporting year, the number of inspections of active construction sites, the percentage of active construction sites inspected, and the number and type of enforcement actions / referrals taken.				
	PERMITTEE SITES: Active construction sites	0			
	PERMITTEE SITES: Pre-, During, and Post inspections of active construction sites for E&S and waste control BMPs	0	Construction Observation Report	Engineering Consultant	
	PERMITTEE SITES: Percentage of active construction sites inspected	N/A			
	PRIVATE SITES: Active construction sites	7			
	PRIVATE SITES: Pre-, During, and Post inspections of active construction sites for E&S and waste control BMPs	7	Construction Observation Report	Engineering Consultant	
	PRIVATE SITES: Percentage of active construction sites inspected	100	Construction Observation Report		
	Enforcement Action	0			

SECTION VII. STORMWATER MANAGEMENT PROGRAM (SWMP) SUMMARY TABLE					
A.	B.	C.	D.	E.	F.
Permit Citation/ SWMP Element	Permit Requirement/Quantifiable SWMP Activity	Number of Activities Performed	Documentation / Record	Entity Performing the Activity	Comments
Part III.A.9.c	Construction Site Runoff — Site Operator Training				
	Report the type of training activities, the number of inspectors, site plan reviewers and site operators trained (both in-house and outside training).				
		DEP Certification	Annual Training		
	Permittee construction site inspectors	3	3	NPBCID	
	Permittee construction site plan reviewers		1	NPBCID	
	Permittee construction site operators				
	Provide an evaluation of the Stormwater Management Program according to Part VI.B.2 of the permit.				
Part III.A.9 Summary	Strengths: Routine Training increases reduction in pollutants				
	Limitations: None				
	SWMP revisions implemented to address limitations: None needed				

SECTION VIII. CHANGES TO THE STORMWATER MANAGEMENT PROGRAM (SWMP) ACTIVITIES (Not Applicable in Year 4)	
A.	<p>Permit Citation/ SWMP Element</p> <p>Proposed Changes to the Stormwater Management Program Activities Established as Specific Requirements Under Part III.A of the Permit (Including the Rationale for the Change) — REQUIRES DEP APPROVAL PRIOR TO CHANGE IF PROPOSING TO REPLACE OR DELETE AN ACTIVITY.</p> <p>N/A</p> <p>N/A</p> <p>N/A</p>
B.	<p>Permit Citation/ SWMP Element</p> <p>Changes to the Stormwater Management Program Activities NOT Established as Specific Requirements Under Part III.A of the Permit (Including the Rationale for the Change)</p> <p>N/A</p> <p>N/A</p> <p>N/A</p>

# SECTION IX. TMDL Status Report

YEAR 1 Provide a table summarizing the status of the TMDL process. Include a list of prioritized TMDLs and their monitoring and implementation schedule; and include the Identification number of the outfall prioritized for TMDL monitoring.

A.	WBID Number	Segment/ Waterbody/ Basin	Pollutant of Concern	TMDL DEP / EPA	Percent Reduction (WLA)	Priority Rank	Priority Outfall	Monitoring Summary / BPCP Due Date	Supplemental SWMP Due Date
	N/A			<input type="checkbox"/> / <input type="checkbox"/>		1		(Year 3 AR)	(Year 4 AR; N/A) if BPCP
				<input type="checkbox"/> / <input type="checkbox"/>					
				<input type="checkbox"/> / <input type="checkbox"/>					

YEAR 3 and annually thereafter, provide a summary of the estimated load reductions that have occurred for the pollutant(s) of concern being discharged from the MS4 to the TMDL water body during the reporting period and cumulatively since the date the Supplemental SWMP was implemented.

Year 3: Submit a Monitoring data summary or BPCP (if applicable).

Year 4: Submit a Supplemental SWMP (if applicable).

B.	WBID Number	Pollutant of Concern	Monitoring Summary / BPCP Submitted	Supplemental SWMP Submitted	Projected load reductions OR Actual load reductions to date				
	N/A		(Year 3 AR)	(Year 4 AR; N/A if BPCP)					

C. Provide a brief statement as to the status of TMDL implementation according to Part VIII.B of the permit (e.g. status of monitoring to validate WLA):

No discharge to a TMDL WBID at the time of permit issuance

## ELEVATION REFERENCE MONUMENT LOCATIONS

32 FT. EAST OF CENTERLINE OF OCEAN GROVE AND 42 FT. SOUTH OF CENTERLINE OF SOUTH JUNCO LANE. ALSO 29 FT. SOUTH OF SOUTH ENTRANCE TO TOWN CENTER AND 1 FT. OFF EAST SIDE OF SIDEWALK.

CENTER OF CROSS ISLAND IN FRONT OF PBC FIRE RESCUE STATION #15 65 FT EAST OF CENTERLINE OF US HWY 1.

31 FT. EAST OF CENTERLINE OF OCEAN DRIVE. ACROSS FROM CENTERLINE OF SOUTH LANE  
1 FT FROM EAST SIDE OF SIDEWALK.

33 FT. EAST OF THE CENTERLINE OF OCEAN DRIVE, 175 FT. NORTH OF THE CENTERLINE OF NORTH CYRA CIRCLE AND 1 FT. OFF EAST SIDE OF SEWERLINE.

27 FT EAST OF THE CENTERLINE OF OCEAN DRIVE 50 FT SOUTH OF THE CENTERLINE OF THE SOUTH TURNOUT OF CELESTIAL WAY AND 3 FT. OFF EAST SIDE OF SIDEWALK

26 FT. EAST OF THE CENTERLINE OF OCEAN DRIVE, 36 FT. SOUTH OF THE CENTERLINE OF DONALD GROSS RD. AND 1 FT. OFF EAST SIDE OF SIDEWALK.

WEST SIDE OF OCEAN DRIVE 10 TO 12 FT. SOUTH OF JUNG BEACH PARK AND 1 TO 2  
E. WEST OF SIDEWALK

EAST OF CELESTIAL WAY ON THE STORM DRAIN HEAD WALL IN FRONT OF COLONY BOND.

23 FT. EAST OF THE CENTERLINE OF OCEAN DRIVE. 13 FT. SOUTH OF THE CENTERLINE OF DIANA LAKE AND 6 FT. WEST OF THE SIDEWALK.

IN THE DUNES TO THE NORTH SIDE OF ATLANTIC OCEAN WALK OVER 4 TO 6 FT NORTH OF THE TOP OF STAIRS

VERIFICATION - MAY, 2002



**REDUCED PLOT  
NOT TO SCALE  
SIZED TO FIT MEDIA**

## Index

OF FOUR

# STORM DRAINAGE SYSTEM MAP TOWN OF JUNO BEACH

ATTACHMENT #1

ID NUMBER	CENTRAL TOWN	PIPE SIZE IN	OUT	TYPE	LENGTH	LOCATION	ID NUMBER	PIPE SIZE IN	OUT	TYPE	LENGTH	LOCATION
J0101C		15"	15"	RCP	195 FT.	500 OCEAN DR.	J0320C	18" S	18" N	CAP	70 FT.	UND LAGO
J0102C		15" N	15" W	RCP	35 FT.	450 OCEAN DR.	J0321C	18" L/S	18" W	CAP	UND LAGO	
J0103C		15" E	15" S	RCP	300 FT.	340 OCEAN DR.	J0322C	18" L/S	18" W	CAP	180 FT.	PPBL
J0104C		15" N/E	24" W	CAP	202 FT.	340 OCEAN DR.	J0323C	18" L/S	18" W	CAP	UND LAGO	
J0105C		24" W/S	24" W	CAP	40 FT.	350 CELESTIAL	J0324C	18" L/S	30" W	CAP	40 FT.	UND LAGO
J0106C		24" W/S	24" W	CAP	40 FT.	340 OCEAN DR.	J0325C	18" L/S	30" W	CAP	ELL. WILL. RD.	
J0107C		24" W/S	24" W	CAP	135 FT.	330 CELESTIAL	J0326C	18" L/S	30" W	CAP	ELL. WILL. RD.	
J0108C		24" W/S	15" W	CAP	10 FT.	350 CELESTIAL	J0327C	18" L/S	30" W	CAP	SEACREST L/S	
J0109C		24" W/S	15" S	RCP	95 FT.	380 CELESTIAL	J0328C	18" L/S	30" W	CAP	20 FT.	SEACREST L/S
J0110C		15" W	15" W	RCP	95 FT.	350 CELESTIAL	J0329C	18" L/S	30" W	CAP	450 FT.	BAY COLONY
J0111C		12" W	12" W	PVC	75 FT.	BEACH BOUND	J0330C	18" L/S	30" W	CAP	300 FT.	BAY COLONY
J0112C		15" W	15" W	RCP	100 FT.	MEXFORD CT.	J0331C	18" L/S	30" W	CAP	172 FT.	INTRACOSTAL
J0113C		15" W	15" W	CAP	300 FT.	COTE DE LAVER	NEW PALM BEACH HEIGHTS					
J0114C		12" W	12" W	PVC	135 FT.	501E DC LAMER	J0420C	18" W	18" W	RCP	35 FT.	PARK STREET
J0115C		15" W	15" W	CAP	100 FT.	BARGLEY	J0421C	18" W	18" W	RCP	Distance 10 and not known.	PARK STREET
J0116C		18" W	18" W	CAP	140 FT.	BESSEMER	J0422C	18" W	18" W	RCP	Distance 10 and not known.	PARK STREET
J0117C		15" N	15" N	CAP	24 FT.	DESSEMER	J0423C	18" W	18" W	RCP	Distance 10 and not known.	PARK STREET
J0118C		15" L	15" L	CAP	12 FT.	SEA SIDE	J0424C	18" W	18" W	RCP	Distance 10 and not known.	PARK STREET
J0119C		15" L	15" L	POLY	140 FT.	NEPTUNE WAY	J0425C	18" W	18" W	RCP	Distance 10 and not known.	PARK STREET
J0120C		15" W	15" W	CAP	103 FT.	340 OCEAN DR.	J0426C	18" W	18" W	RCP	Distance 10 and not known.	PARK STREET
J0121C		15" W	15" W	CAP	40 FT.	340 OCEAN DR.	J0427C	18" W	18" W	RCP	Distance 10 and not known.	PARK STREET
J0122C		15" W	15" W	CAP	130 FT.	340 OCEAN DR.	J0428C	18" W	18" W	RCP	Distance 10 and not known.	PARK STREET
J0123C		15" W	15" W	CAP	37 FT.	340 OCEAN DR.	J0429C	18" W	18" W	RCP	Distance 10 and not known.	PARK STREET
J0124C		15" W	15" W	CAP	40 FT.	340 OCEAN DR.	J0430C	18" W	18" W	RCP	Distance 10 and not known.	PARK STREET
J0125C		15" W	15" W	CAP	110 FT.	340 OCEAN DR.	J0431C	18" W	18" W	RCP	Distance 10 and not known.	PARK STREET
J0126C		15" W	15" W	CAP	163 FT.	340 OCEAN DR.	J0432C	18" W	18" W	RCP	Distance 10 and not known.	PARK STREET
J0127C		15" W	15" W	CAP	163 FT.	340 OCEAN DR.	J0433C	18" W	18" W	RCP	Distance 10 and not known.	PARK STREET
J0128C		15" W	15" W	CAP	163 FT.	340 OCEAN DR.	J0434C	18" W	18" W	RCP	Distance 10 and not known.	PARK STREET
J0129C		15" W	15" W	CAP	163 FT.	340 OCEAN DR.	J0435C	18" W	18" W	RCP	Distance 10 and not known.	PARK STREET
J0130C		15" W	15" W	CAP	163 FT.	340 OCEAN DR.	J0436C	18" W	18" W	RCP	Distance 10 and not known.	PARK STREET
J0131C		15" W	15" W	CAP	163 FT.	340 OCEAN DR.	J0437C	18" W	18" W	RCP	Distance 10 and not known.	PARK STREET
J0132C		15" W	15" W	CAP	163 FT.	340 OCEAN DR.	J0438C	18" W	18" W	RCP	Distance 10 and not known.	PARK STREET
J0133C		15" W	15" W	CAP	163 FT.	340 OCEAN DR.	J0439C	18" W	18" W	RCP	Distance 10 and not known.	PARK STREET
J0134C		15" W	15" W	CAP	163 FT.	340 OCEAN DR.	J0440C	18" W	18" W	RCP	Distance 10 and not known.	PARK STREET
J0135C		15" W	15" W	CAP	163 FT.	340 OCEAN DR.	J0441C	18" W	18" W	RCP	Distance 10 and not known.	PARK STREET
J0136C		15" W	15" W	CAP	163 FT.	340 OCEAN DR.	J0442C	18" W	18" W	RCP	Distance 10 and not known.	PARK STREET
J0137C		15" W	15" W	CAP	163 FT.	340 OCEAN DR.	J0443C	18" W	18" W	RCP	Distance 10 and not known.	PARK STREET
J0138C		15" W	15" W	CAP	163 FT.	340 OCEAN DR.	J0444C	18" W	18" W	RCP	Distance 10 and not known.	PARK STREET
J0139C		15" W	15" W	CAP	163 FT.	340 OCEAN DR.	J0445C	18" W	18" W	RCP	Distance 10 and not known.	PARK STREET
J0140C		15" W	15" W	CAP	163 FT.	340 OCEAN DR.	J0446C	18" W	18" W	RCP	Distance 10 and not known.	PARK STREET
J0141C		15" W	15" W	CAP	163 FT.	340 OCEAN DR.	J0447C	18" W	18" W	RCP	Distance 10 and not known.	PARK STREET
J0142C		15" W	15" W	CAP	163 FT.	340 OCEAN DR.	J0448C	18" W	18" W	RCP	Distance 10 and not known.	PARK STREET
J0143C		15" W	15" W	CAP	163 FT.	340 OCEAN DR.	J0449C	18" W	18" W	RCP	Distance 10 and not known.	PARK STREET
J0144C		15" W	15" W	CAP	163 FT.	340 OCEAN DR.	J0450C	18" W	18" W	RCP	Distance 10 and not known.	PARK STREET
J0145C		15" W	15" W	CAP	163 FT.	340 OCEAN DR.	J0451C	18" W	18" W	RCP	Distance 10 and not known.	PARK STREET
J0146C		15" W	15" W	CAP	163 FT.	340 OCEAN DR.	J0452C	18" W	18" W	RCP	Distance 10 and not known.	PARK STREET
J0147C		15" W	15" W	CAP	163 FT.	340 OCEAN DR.	J0453C	18" W	18" W	RCP	Distance 10 and not known.	PARK STREET
J0148C		15" W	15" W	CAP	163 FT.	340 OCEAN DR.	J0454C	18" W	18" W	RCP	Distance 10 and not known.	PARK STREET
J0149C		15" W	15" W	CAP	163 FT.	340 OCEAN DR.	J0455C	18" W	18" W	RCP	Distance 10 and not known.	PARK STREET
J0150C		15" W	15" W	CAP	163 FT.	340 OCEAN DR.	J0456C	18" W	18" W	RCP	Distance 10 and not known.	PARK STREET
J0151C		15" W	15" W	CAP	163 FT.	340 OCEAN DR.	J0457C	18" W	18" W	RCP	Distance 10 and not known.	PARK STREET
J0152C		15" W	15" W	CAP	163 FT.	340 OCEAN DR.	J0458C	18" W	18" W	RCP	Distance 10 and not known.	PARK STREET
J0153C		15" W	15" W	CAP	163 FT.	340 OCEAN DR.	J0459C	18" W	18" W	RCP	Distance 10 and not known.	PARK STREET
J0154C		15" W	15" W	CAP	163 FT.	340 OCEAN DR.	J0460C	18" W	18" W	RCP	Distance 10 and not known.	PARK STREET
J0155C		15" W	15" W	CAP	163 FT.	340 OCEAN DR.	J0461C	18" W	18" W	RCP	Distance 10 and not known.	PARK STREET
J0156C		15" W	15" W	CAP	163 FT.	340 OCEAN DR.	J0462C	18" W	18" W	RCP	Distance 10 and not known.	PARK STREET
J0157C		15" W	15" W	CAP	163 FT.	340 OCEAN DR.	J0463C	18" W	18" W	RCP	Distance 10 and not known.	PARK STREET
J0158C		15" W	15" W	CAP	163 FT.	340 OCEAN DR.	J0464C	18" W	18" W	RCP	Distance 10 and not known.	PARK STREET
J0159C		15" W	15" W	CAP	163 FT.	340 OCEAN DR.	J0465C	18" W	18" W	RCP	Distance 10 and not known.	PARK STREET
J0160C		15" W	15" W	CAP	163 FT.	340 OCEAN DR.	J0466C	18" W	18" W	RCP	Distance 10 and not known.	PARK STREET
J0161C		15" W	15" W	CAP	163 FT.	340 OCEAN DR.	J0467C	18" W	18" W	RCP	Distance 10 and not known.	PARK STREET
J0162C		15" W	15" W	CAP	163 FT.	340 OCEAN DR.	J0468C	18" W	18" W	RCP	Distance 10 and not known.	PARK STREET
J0163C		15" W	15" W	CAP	163 FT.	340 OCEAN DR.	J0469C	18" W	18" W	RCP	Distance 10 and not known.	PARK STREET
J0164C		15" W	15" W	CAP	163 FT.	340 OCEAN DR.	J0470C	18" W	18" W	RCP	Distance 10 and not known.	PARK STREET
J0165C		15" W	15" W	CAP	163 FT.	340 OCEAN DR.	J0471C	18" W	18" W	RCP	Distance 10 and not known.	PARK STREET
J0166C		15" W	15" W	CAP	163 FT.	340 OCEAN DR.	J0472C	18" W	18" W	RCP	Distance 10 and not known.	PARK STREET
J0167C		15" W	15" W	CAP	163 FT.	340 OCEAN DR.	J0473C	18" W	18" W	RCP	Distance 10 and not known.	PARK STREET
J0168C		15" W	15" W	CAP	163 FT.	340 OCEAN DR.	J0474C	18" W	18" W	RCP	Distance 10 and not known.	PARK STREET
J0169C		15" W	15" W	CAP	163 FT.	340 OCEAN DR.	J0475C	18" W	18" W	RCP	Distance 10 and not known.	PARK STREET
J0170C		15" W	15" W	CAP	163 FT.	340 OCEAN DR.	J0476C	18" W	18" W	RCP	Distance 10 and not known.	PARK STREET
J0171C		15" W	15" W	CAP	163 FT.	340 OCEAN DR.	J0477C	18" W	18" W	RCP	Distance 10 and not known.	PARK STREET
J0172C		15" W	15" W	CAP	163 FT.	340 OCEAN DR.	J0478C	18" W	18" W	RCP	Distance 10 and not known.	PARK STREET
J0173C		15" W	15" W	CAP	163 FT.	340 OCEAN DR.	J0479C	18" W	18" W	RCP	Distance 10 and not known.	PARK STREET
J0174C		15" W	15" W	CAP	163 FT.	340 OCEAN DR.	J0480C	18" W	18" W	RCP	Distance 10 and not known.	PARK STREET
J0175C		15" W	15" W	CAP	163 FT.	340 OCEAN DR.	J0481C	18" W	18" W	RCP	Distance 10 and not known.	PARK STREET
J0176C		15" W	15" W	CAP	163 FT.	340 OCEAN DR.	J0482C	18" W	18" W	RCP	Distance 10 and not known.	PARK STREET
J0177C		15" W	15" W	CAP	163 FT.	340 OCEAN DR.	J0483C	18" W	18" W	RCP	Distance 10 and not known.	PARK STREET
J0178C		15" W	15" W	CAP	163 FT.	340 OCEAN DR.	J0484C	18" W	18" W	RCP	Distance 10 and not known.	PARK STREET
J0179C		15" W	15" W	CAP	163 FT.	340 OCEAN DR.	J0485C	18" W	18" W	RCP	Distance 10 and not known.	PARK STREET
J0180C		15" W	15" W	CAP	163 FT.	340 OCEAN DR.	J0486C	18" W	18" W	RCP	Distance 10 and not known.	PARK STREET
J0181C		15" W	15" W	CAP	163 FT.	340 OCEAN DR.	J0487C	18" W	18" W	RCP	Distance 10 and not known.	PARK STREET
J0182C		15" W	15" W	CAP	163 FT.	340 OCEAN DR.	J0488C	18" W	18" W	RCP	Distance 10 and not known.	PARK STREET
J0183C		15" W	15" W	CAP	163 FT.	340 OCEAN DR.	J0489C	18" W	18" W	RCP	Distance 10 and not known.	PARK STREET
J0184C		15" W	15" W	CAP	163 FT.	340 OCEAN DR.	J0490C	18" W	18" W	RCP	Distance 10 and not known.	PARK STREET
J0185C		15" W	15" W	CAP	163 FT.	340 OCEAN DR.	J0491C	18" W	18" W	RCP	Distance 10 and not known.	PARK STREET
J0186C		15" W	15" W	CAP	163 FT.	340 OCEAN DR.	J0492C	18" W	18" W	RCP	Distance 10 and not known.	PARK STREET
J0187C		15" W	15" W	CAP	163 FT.	340 OCEAN DR.	J0493C	18" W	18" W	RCP	Distance 10 and not known.	PARK STREET
J0188C		15" W	15" W	CAP	163 FT.	340 OCEAN DR.	J0494C	18" W	18" W	RCP	Distance 10 and not known.	PARK STREET
J0189C		15" W	15" W	CAP	163 FT.	340 OCEAN DR.	J0495C	18" W	18" W	RCP	Distance 10 and not known.	PARK STREET
J0190C		15" W	15" W	CAP	163 FT.	340 OCEAN DR.	J0496C	18" W	18" W	RCP	Distance 10 and not known.	PARK STREET
J0191C		15" W	15" W	CAP	163 FT.	340 OCEAN DR.	J0497C	18" W	18" W	RCP	Distance 10 and not known.	PARK STREET
J0192C		15" W	15" W	CAP	163 FT.	340 OCEAN DR.	J0498C	18" W	18" W	RCP	Distance 10 and not known.	PARK STREET
J0193C		15" W	15" W	CAP	163 FT.	340 OCEAN DR.	J0499C	18" W	18" W	RCP	Distance 10 and not known.	PARK STREET
J0194C		15" W	15" W	CAP	163 FT.	340 OCEAN DR.	J0500C	18" W	18" W	RCP	Distance 10 and not known.	PARK STREET
J0195C		15" W	15" W	CAP	163 FT.	340 OCEAN DR.	J0501C	18" W	18" W	RCP	Distance 10 and not known.	PARK STREET
J0196C		15" W	15" W	CAP	163 FT.	340 OCEAN DR.	J0502C	18" W	18" W	RCP	Distance 10 and not known.	PARK STREET
J0197C		15" W	15" W	CAP	163 FT.	340 OCEAN DR.	J0503C	18" W	18" W	RCP	Distance 10 and not known.	PARK STREET
J0198C		15" W	15" W	CAP	163 FT.	340 OCEAN DR.	J0504C	18" W	18" W	RCP	Distance 10 and not known.	PARK STREET
J0199C		15" W	15" W	CAP	163 FT.	340 OCEAN DR.	J0505C	18" W	18" W	RCP	Distance 10 and not known.	PARK STREET
J0200C		15" W	15" W	CAP	163 FT.	340 OCEAN DR.	J0506C	18" W	18" W	RCP	Distance 10 and not known.	PARK STREET
J0201C		15" W	15" W	CAP	163 FT.	340 OCEAN DR.	J0507C	18" W	18" W	RCP	Distance 10 and not known.	PARK STREET
J0202C		15" W	15" W	CAP	163 FT.	340 OCEAN DR.	J0508C	18" W	18" W	RCP	Distance 10 and not known.	PARK STREET
J0203C		15" W	15" W	CAP	163 FT.	340 OCEAN DR.	J0509C	18" W	18" W	RCP	Distance 10 and not known.	PARK STREET
J0204C		15" W	15" W	CAP	163 FT.	340 OCEAN DR.	J0510C	18" W	18" W	RCP	Distance 10 and not known.	PARK STREET
J0205C		15" W	15" W	CAP	163 FT.	340 OCEAN DR.	J0511C	18" W	18" W	RCP	Distance 10 and not known.	PARK STREET
J0206C		15" W	15" W	CAP	163 FT.	340 OCEAN DR.	J0512C	18" W	18" W	RCP	Distance 10 and not known.	PARK STREET
J0207C		15" W	15" W	CAP	163 FT.	340 OCEAN DR.	J0513C	18" W	18" W	RCP	Distance 10 and not known.	

STRUCTURE TYPE DESIGNATIONS C-CATCH BASIN M-HANDHOLE S-SPILLWAY

PALM BEACH CO.

## CORPORATE LIMITS

**NORTH TOWN**

ATLANTIC OCEAN

MAP COURTESY OF  
*Jay Nelson Cadd*

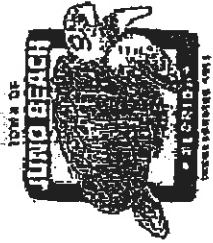

0 100 200  
SCALE IN FEET  
1"=100'

ATLANTIC OCEAN

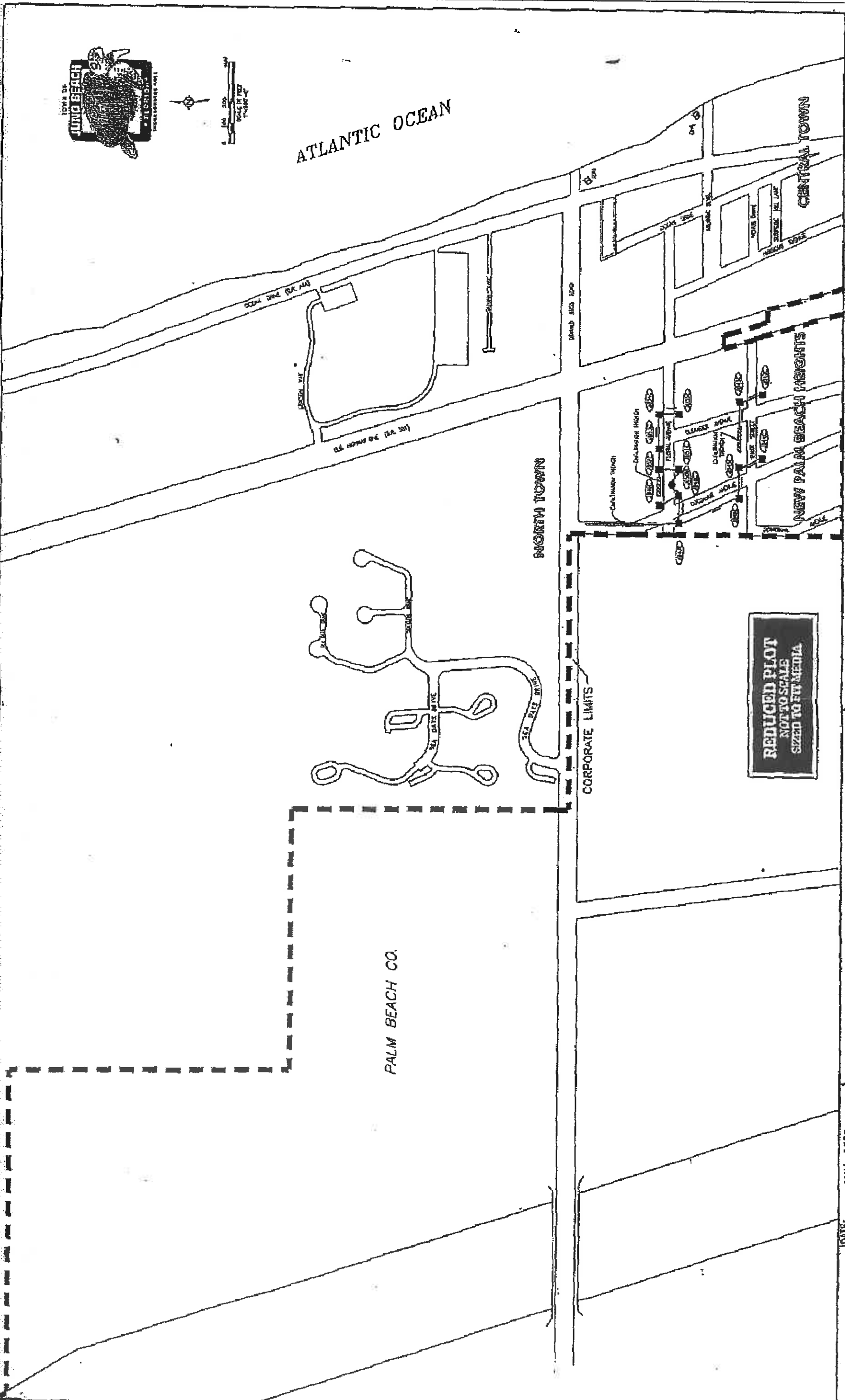

# STORM DRAINAGE SYSTEM MAP TOWN OF JUNO BEACH

SHEET  
OF FOUR

2

ATTACHMENT #1

DATE: MAY, 2002

FILE: JB02E01A.DWG

REVISED: MAY, 2003

MAP COURTESY OF

Jay Nelson Cadd

## LEGEND

- CATCH BASIN (MUT)
- MANHOLE
- CATCH BASIN (NOCH) DEAM
- CONCRETE STRUCTURE
- FLOW JUNCTION
- LOCATION REFERENCE MARK

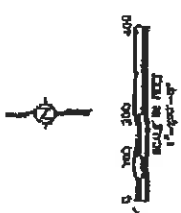

ATLANTIC OCEAN

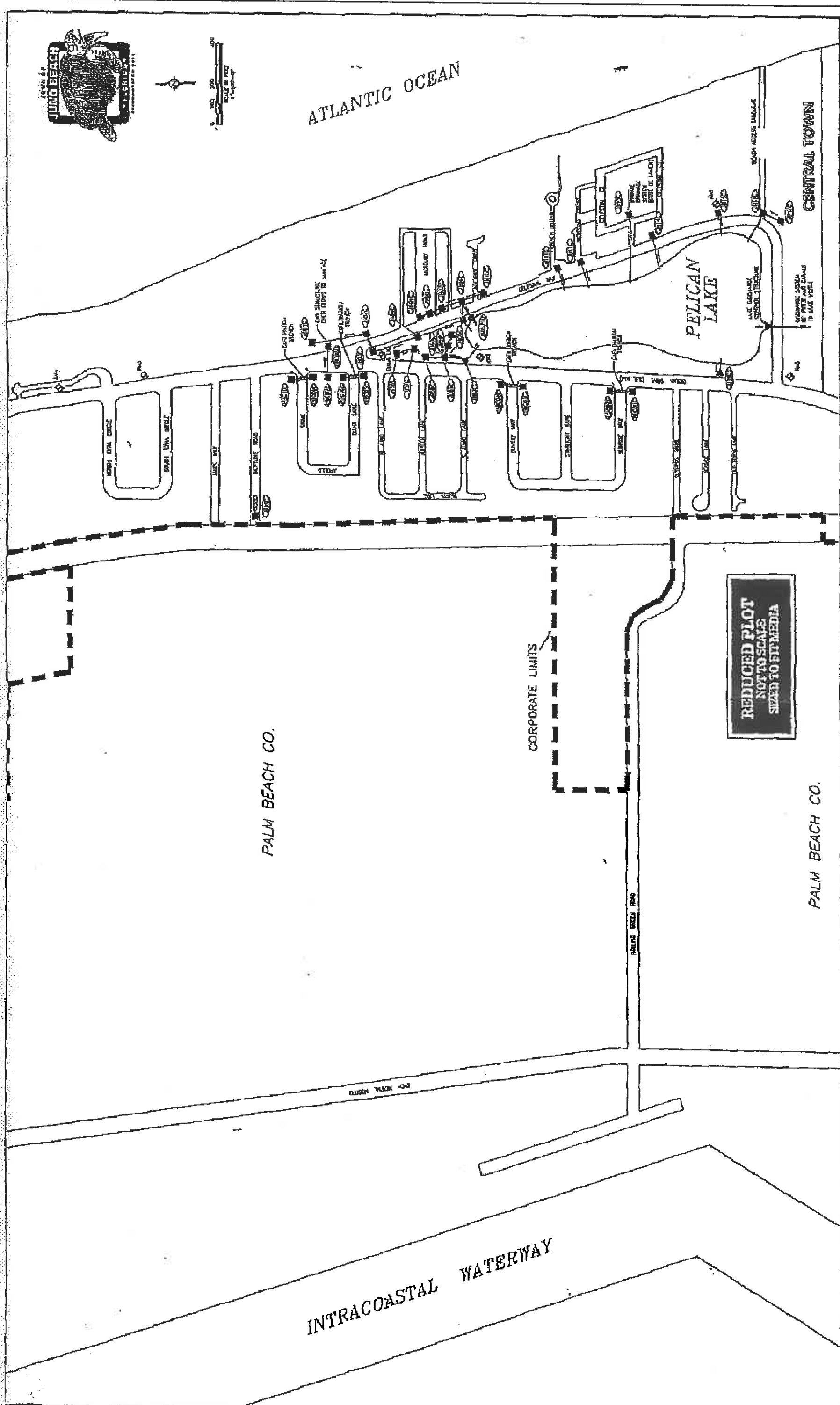

STORM DRAINAGE SYSTEM MAP  
TOWN OF JUNO BEACH

SHEET  
3  
OF FOUR

ATTACHMENT #1

LEGEND			
■	CATCH BASIN (WALL)	▲	CONTROL STRUCTURE
●	MANHOLE	—	FLOW ARROW
□	CATCH BASIN (FLOOR) DRAIN	◆	ELEVATION INDICATOR MARK

DATE:	MAY, 2002
FILE:	JB02ED1A.DWG
REVISED:	MAY, 2003

MAP COURTESY OF  
**Jay Nelson Cadd**

INTRACOASTAL WATERWAY

PALM BEACH CO.

CORPORATE LIMITS

PALM BEACH CO.

REDUCED PLOT  
NOT TO SCALE  
SIZED TO FIT MEDIA

PELICAN LAKE

CENTRAL TOWN



