



Annual Report Form For Individual NPDES Permits For Municipal Separate Storm Sewer Systems (RULE 62-624.600(2), F.A.C.)

- This Annual Report Form must be completed and submitted to the Department to satisfy the annual reporting requirements established in Rule 62-621.600, F.A.C.
- Submit this fully completed and signed form and any REQUIRED attachments by email to the NPDES Stormwater Program Administrator or to the MS4 coordinator (<http://www.dep.state.fl.us/water/stormwater/npdes/contacts.htm>). Files larger than 10MB may be placed on the FTP site at: ftp://ftp.dep.state.fl.us/pub/NPDES_Stormwater/. After uploading files, email the MS4 coordinator or NPDES Program Administrator to notify them the report is ready for downloading; or by mail to the address in the box at right.
- Refer to the Form Instructions for guidance on completing each section.
- **Please print or type information in the appropriate areas below.**

Submit the form and attachments to:
 Florida Department of Environmental Protection
 Mail Station 3585
 2600 Blair Stone Road
 Tallahassee, Florida 32399-2400

SECTION I. BACKGROUND INFORMATION

A.	Permittee Name: Town of Cloud Lake		
B.	Permit Name: Palm Beach County MS4		
C.	Permit Number: FLS000018-004 (Cycle 4)		
D.	Annual Report Year: <input checked="" type="checkbox"/> Year 1 <input type="checkbox"/> Year 2 <input type="checkbox"/> Year 3 <input type="checkbox"/> Year 4 <input type="checkbox"/> Year 5 <input type="checkbox"/> Other, specify Year:		
E.	Reporting Time Period (month/year): 10/01/16 through 9 /30/17		
F.	Name of the Responsible Authority: W. Patrick Slatery		
	Title: Mayor		
	Mailing Address: 100 Lang Road		
	City: Cloud Lake	Zip Code: 33406	County: Palm Beach
	Telephone Number: (561) 686-2815		Fax Number: (561) 683-5120
G.	E-mail Address: townofcloudlake@msn.com		
	Name of the Designated Stormwater Management Program Contact (if different from Section I.F above): Dorothy C. Gravelin		
	Title: Town Clerk		
	Department: Clerk's Office		
	Mailing Address: 100 Lang Road		
	City: Cloud Lake	Zip Code: 33406	County: Palm Beach
H.	Telephone Number: (561) 686-2815		Fax Number: (561) 683-5120
	E-mail Address: townofcloudlake@msn.com		

SECTION II. MS4 MAJOR OUTFALL INVENTORY (Not Applicable in Year 1)

A.	Number of outfalls ADDED to the outfall inventory in the current reporting year (insert "0" if none): 0 (Does this number include non-major outfalls? <input type="checkbox"/> Yes <input type="checkbox"/> No <input checked="" type="checkbox"/> Not Applicable)
B.	Number of outfalls REMOVED from the outfall inventory in the current reporting year (insert "0" if none): 0 (Does this number include non-major outfalls? <input type="checkbox"/> Yes <input type="checkbox"/> No <input checked="" type="checkbox"/> Not Applicable)
C.	Is the change in the total number of outfalls due to lands annexed or vacated? <input type="checkbox"/> Yes <input type="checkbox"/> No <input checked="" type="checkbox"/> Not Applicable

SECTION III. PART V.B. ASSESSMENT PROGRAM

A.	<p>Provide a brief statement as to the status of water quality monitoring plan implementation. Status may include sampling frequency changes, monitoring location changes, or sampling waiver conditions. <u>DEP Note:</u> If permittee participates in a collaborative monitoring plan, permittee may refer to a joint response as defined by the interlocal agreement.</p> <p>Name and date of the approved plan: <i>Current approved plan for the Group Monitoring Plan is September 8, 2016 (with issuance of the Cycle 4 permit). Our newly-developed, individual Assessment Plan was submitted on 9/8/17.</i></p> <p>Status: <i>The Group Monitoring Report is included in the Cycle 4, Year 1 Joint Annual Report. The newly-developed, individual Assessment Plan is awaiting approval by FDEP.</i></p>
B.	<p>Provide a brief discussion of the monitoring and loading results to date which includes a summary of the water quality monitoring data and / or stormwater pollutant loading changes from the reporting year. <u>DEP Note:</u> Results must be specific to the permittee's SWMP.</p> <p><i>Please refer to the Cycle 4, Year 1 Joint Annual Report for a summary of the Group's water quality monitoring results for the reporting period. Refer to the Cycle 3, Year 6 Joint Annual Report for proposed pollutant loading analysis changes. The best available information on existing pollutant loading estimates is documented in the Cycle 3, Year 3 Joint Annual Report.</i></p> <p><i>The newly-developed, individual Assessment Plan is under review by FDEP and will be implemented during Year 2 of the permit cycle. Note that in any future reporting year, the Group's water quality monitoring data for the reporting period may not be available for 4 to 6 months after the reporting period has ended. Consequently, any water quality data from the Group Program that is used as part of an individual permittee's Assessment Plan for the reporting period, will be based on the previous year's data.</i></p>
C.	<p>Attach a monitoring data summary as required by the permit. An analysis of the data discussing changes in water quality and/or stormwater pollutant loading from previous reporting years. <u>DEP Note:</u> Analysis must be specific to the permittee's SWMP.</p> <p><i>See response for Section III.B., above.</i></p>

SECTION IV. FISCAL ANALYSIS

A.	Total expenditures for the NPDES stormwater management program for the current reporting year: \$ 17,841
B.	Total budget for the NPDES stormwater management program for the subsequent reporting year: \$ 18,533

C.	Did subsequent program resources decrease from the current reporting period? Y <input type="checkbox"/> / N X (Fill-In after fiscal analysis)
	If program resources decreased, provide a discussion of the impacts on the implementation of the SWMP.
	Not Applicable (N/A)

SECTION V. MATERIALS TO BE SUBMITTED WITH THIS ANNUAL REPORT FORM				
Only the following materials are to be submitted to the Department along with this fully completed and signed Annual Report Form (check the appropriate box to indicate whether the item is attached or is not applicable):				
Attached	N/A	Required Attachments	Permit Citation	Attachment Number/Title
<input type="checkbox"/>	X	Any additional information required to be submitted in this current annual reporting year in accordance with Part III.A of your permit that is not otherwise included in Section VII below.	Part III.A	
<input type="checkbox"/>	X	If program resources have decreased from the previous year, a discussion of the impacts on the implementation of the SWMP.	Part II.F	
<input type="checkbox"/>	X	An explanation of why the minimum inspection frequency in Table II.A.1.a. was not met, if applicable.	Part II.A.1	
<input type="checkbox"/>	X	A list of the flood control projects that did not include stormwater treatment and an explanation for each of why it did not (if applicable).	Part III.A.4	
<input type="checkbox"/>	X	A monitoring data summary as directed in Section III.C above and in accordance with Rule 62-624.600(2)(c), F.A.C.	Part V.B.3	
X	<input type="checkbox"/>	YEAR 1 ONLY: An inventory of all known major outfalls and a map depicting the location of the major outfalls (hard copy or CD-ROM) in accordance with Rule 62-624.600(2)(a), F.A.C.	Part III.A.1	1 Stormwater/Drainage System Map
<input type="checkbox"/>	X	YEAR 2: A summary review of codes and regulations to reduce the stormwater impact from development.	Part III.A.2	
<input type="checkbox"/>	X	Year 3 ONLY: The estimates of pollutant loadings and event mean concentrations for each major outfall or each major watershed in accordance with Rule 62-624.600(2)(b), F.A.C.	Part V.A	
<input type="checkbox"/>	X	YEAR 3: Summary of TMDL Monitoring Results (if applicable).	Part VIII.B.2	
<input type="checkbox"/>	X	YEAR 3: Bacteria Pollution Control Plan (if applicable).	Part VIII.B.3	
<input type="checkbox"/>	X	YEAR 4: A follow-up report on plan implementation of changes to codes and regulations to reduce the stormwater impact from development.	Part III.A.2	
<input type="checkbox"/>	X	YEAR 4: A report on any amendments to the applicable legal authority (if applicable).	Part III.A.7.a	
<input type="checkbox"/>	X	YEAR 4: Permit re-application information in accordance with Rule 62-624.420(2), F.A.C. <ul style="list-style-type: none"> The monitoring plan (with revisions, if applicable). If the total annual pollutant loadings have not decreased over the past two permit cycles, revisions to the SWMP, as appropriate. 	Part V.B.3 Part V.A.3	
<input type="checkbox"/>	X	YEAR 4: TMDL Supplemental SWMP (if applicable).	Part VIII.B.3	
DO NOT SUBMIT ANY OTHER MATERIALS (such as records and logs of activities, monitoring raw data, public outreach materials, etc.)				

SECTION VI. CERTIFICATION STATEMENT AND SIGNATURE

The Responsible Authority listed in Section I.F above must sign the following certification statement, as per Rule 62-620.305, F.A.C:

I certify under penalty of law that this document and all attachments were prepared under my direction or supervision in accordance with a system designed to assure that qualified personnel properly gathered and evaluated the information submitted. Based upon my inquiry of the person or persons who manage the system, or those persons directly responsible for gathering the information, the information submitted is, to the best of my knowledge and belief, true, accurate and complete. I am aware that there are significant penalties for submitting false information, including the possibility of fine and imprisonment for knowing violations.

Name of Responsible Authority (type or print): W. Patrick Slatery

Title: Mayor

Signature: W Patrick Slatery

Date: 12 / 15 / 17

SECTION VII. STORMWATER MANAGEMENT PROGRAM (SWMP) SUMMARY TABLE									
A.	B.					C.	D.	E.	F.
Permit Citation/ SWMP Element	Permit Requirement/Quantifiable SWMP Activity					Number of Activities Performed	Documentation / Record	Entity Performing the Activity	Comments
Part III.A.1	Structural Controls and Stormwater Collection Systems Operation								
	Report the current known inventory. Report the number of inspection and maintenance activities conducted for each applicable type of structure included in Table II.A.1.a, and the percentage of the total inventory of each type of structure inspected and maintained. <i>Note: Delete structures that are not in your MS4's inventory. The permittee may choose its own unit of measurement for each structural control to be consistent with the unit of measurement in the documentation. Unit options include: miles, linear feet, acres, etc.</i>								
	Type of Structure	Number of Structures	Number of Inspections	Percent Inspected	Number of Maintenance Activities	Percent Maintained			
	Roadway Grass Swales (miles)	1.6	1	100	0	100	Roadway Grass Swale- Structural Control Inspection Form	Dorothy Gravelin/Town Clerk	FY 16/17 Log
	Non-Roadway Grass Swales (linear feet)	336	1	100	0	100	Non-Roadway Grass Swale- Structural Control Inspection Form	Town Clerk	FY 16/17 Log
	Wet Detention Systems	2	2	100	0	100	Wet Detention System- Structural Control Inspection Form	Town Clerk	FY 16/17 Log
	Stormwater Pump Stations	1	2	100	0	100	Stormwater Pump Station #1 - Structural Control Inspection Form	Town Clerk	FY 16/17 Log
	Major Stormwater Outfalls	2	2	100	0	100	Major Stormwater Outfalls #1 & 2 - Structural Control Inspection Form	Town Clerk	FY 16/17

SECTION VII. STORMWATER MANAGEMENT PROGRAM (SWMP) SUMMARY TABLE										
A.	B.				C.		D.	E.	F.	
Permit Citation/ SWMP Element	Permit Requirement/Quantifiable SWMP Activity				Number of Activities Performed		Documentation / Record	Entity Performing the Activity	Comments	
	<div>Floodgate</div> <div>Pipes/Culverts (linear feet)</div> <div>Inlets/Catch Basins/Grates</div>	1	1	100	0	100	Control Structure #1 Inspection Procedure/ Checklist/Form	Town Clerk	FY 16/17 Log	
		90	2	100	0	100	Pipes/Culverts - Structural Control Inspection Form	Town Clerk	FY 16/17 Log	
		3	3	100	0	100	Inlets/Catch Bains/Grates #1,2 & 3 - Structural Control Inspection Form	Town Clerk	FY 16/17 Log	
	If the minimum inspection frequencies set forth in Table II.A.1.a. were not met, provide as an attachment an explanation of why they were not and a description of the actions that will be taken to ensure that they will be met.				See above		All documentation listed above	Town Clerk	All minimum inspection frequencies met or exceeded	

SECTION VII. STORMWATER MANAGEMENT PROGRAM (SWMP) SUMMARY TABLE					
A.	B.	C.	D.	E.	F.
Permit Citation/ SWMP Element	Permit Requirement/Quantifiable SWMP Activity	Number of Activities Performed	Documentation / Record	Entity Performing the Activity	Comments
Part III.A.1 Summary	Provide an evaluation of the Stormwater Management Program according to Part VI.B.2 of the permit.				
	Strengths: Structural controls in good operating condition requiring minimal maintenance at the present time.				
	Limitations: None identified.				
	SWMP revisions implemented to address limitations: None needed.				
Part III.A.2	Areas of New Development and Significant Redevelopment				
	Report the number of significant development projects, including new and redevelopment, reviewed and approved by the permittee for post-development stormwater considerations.				
	Number of significant development projects reviewed	0	Site Plan Review Procedures contained in Stormwater Management Plan (SWMP)	Town Clerk	No new development or redevelopment during the permit year
	Number of significant development projects approved	0	Site Plan Review Procedures contained in the SWMP	Town Clerk	No new development or redevelopment during the permit year
	Provide in the Year 2 Annual Report the summary report of the review activity. Provide in the Year 4 Annual Report the follow-up report on plan implementation.				
	Year 2 ONLY: Attach the summary report of the review activity	0			N/A
	Year 4 ONLY: Attach the follow-up report on plan implementation	0			N/A
Part III.A.2 Summary	Provide an evaluation of the Stormwater Management Program according to Part VI.B.2 of the permit.				
	Strengths: Primarily a low density residential community that is nearly built-out; commercial zoned parcels are currently vacant and undeveloped.				
	Limitations: None identified				
	SWMP revisions implemented to address limitations: None				
Part III.A.3	Roadways				
	Report on the litter control program, including the frequency of litter collection, an estimate of the total number of road miles cleaned or amount of area covered by the activities, and an estimate of the quantity of litter collected. <i>Note: If the permittee does not contract activities, delete CONTRACTOR activities.</i>				
	PERMITTEE Litter Control: Frequency of litter collection	Monthly	Monthly Inspection Checklist Sheets	Town Clerk	Property owners are responsible for litter and trash removal in the swale areas as

SECTION VII. STORMWATER MANAGEMENT PROGRAM (SWMP) SUMMARY TABLE					
A.	B.	C.	D.	E.	F.
Permit Citation/ SWMP Element	Permit Requirement/Quantifiable SWMP Activity	Number of Activities Performed	Documentation / Record	Entity Performing the Activity	Comments
					part of the roadway swale maintenance program
	PERMITTEE Litter Control: Estimated amount of area maintained (miles)	1.6	Town Map	Town Clerk	FY 16/17 Log
	PERMITTEE Litter Control: Estimated amount of litter collected (bags)	1	Monthly Inspection Checklist Sheets	Town Clerk	FY 16/17 Log
	CONTRACTOR Litter Control: Frequency of litter collection	0			No private contractor
	CONTRACTOR Litter Control: Estimated amount of area maintained (linear feet)	0			N/A
	CONTRACTOR Litter Control: Estimated amount of litter collected (cy)				
	OPTIONAL: If an Adopt-A-Road or similar program is implemented, report the total number of road miles cleaned and an estimate of the quantity of litter collected. If you do not participate in an Adopt-A-Road program, report "0".				
	Trash Pick-up Events: Total miles cleaned	0			No program needed; all local streets
	Trash Pick-up Events: Estimated amount of litter collected (cubic yards)	0			No program needed; all local streets
	Adopt-A-Road: Total miles cleaned	0			No program needed
	Adopt-A-Road: Estimated amount of litter collected (cubic yards)	0			No program needed
	Report on the street sweeping program, including the frequency of the sweeping, total miles swept, an estimate of the quantity of sweepings collected, and the total nitrogen and total phosphorus loadings that were removed by the collection of sweepings. If no street sweeping program is implemented, provide the explanation of why not in column F.				
	Frequency of street sweeping	0			The Town roadway system is entirely served by grass swales; there are no curb and gutters
	Total miles swept	0			N/A
	Estimated quantity of sweeping material collected (cy / tons)	0			N/A
Total phosphorous loadings removed (pounds)	0			N/A	
Total nitrogen loadings removed (pounds)	0			N/A	

SECTION VII. STORMWATER MANAGEMENT PROGRAM (SWMP) SUMMARY TABLE					
A.	B.	C.	D.	E.	F.
Permit Citation/ SWMP Element	Permit Requirement/Quantifiable SWMP Activity	Number of Activities Performed	Documentation / Record	Entity Performing the Activity	Comments
	Report the equipment yards and maintenances shops that support road maintenance activities, and the number of inspections conducted for each facility.				
	Name of Facility	Number of Inspections			
	N/A	0			No municipal facilities
Part III.A.3 Summary	Provide an evaluation of the Stormwater Management Program according to Part VI.B.2 of the permit.				
	Strengths: Roadway system consists of all local streets; litter control is performed by individual property owners requiring no contracted services; Town size (68 acres approximately) and small population creates minimal impact on local streets and litter control issues.				
	Limitations: None identified				
	SWMP revisions implemented to address limitations: None				
Part III.A.4	Flood Control Projects				
	Report the total number of flood control projects that were constructed by the permittee during the reporting period and the number of those projects that did NOT include stormwater treatment. The permittee shall provide a list of the projects where stormwater treatment was not included with an explanation for each of why it was not.				
	Report on any stormwater retrofit planning activities and the associated implementation of retrofitting projects to reduce stormwater pollutant loads from existing drainage systems that do not have treatment BMPs.				
	Flood control projects completed during the reporting period	0			No flood control projects during the permit year
	Flood control projects completed that did <u>not</u> include stormwater treatment	0			N/A
	Stormwater retrofit projects planned/under construction	0			None planned
	Stormwater retrofit projects completed	0			N/A
	If there were projects that did not include stormwater treatment, provide as an attachment a list of the projects and an explanation for each of why it did not.	N/A			
Part III.A.4 Summary	Provide an evaluation of the Stormwater Management Program according to Part VI.B.2 of the permit.				
	Strengths: Recent improvements were made to the overall stormwater system (performed in past permit years); there is no imminent or identifiable flood control project needs; none identified in the Town's Capital Improvements Element (CIE) or 5-Year Schedule of Improvements of the Town of Cloud Lake Comprehensive Plan.				
	Limitations: None identified				
	SWMP revisions implemented to address limitations: None				

SECTION VII. STORMWATER MANAGEMENT PROGRAM (SWMP) SUMMARY TABLE					
A.	B.	C.	D.	E.	F.
Permit Citation/ SWMP Element	Permit Requirement/Quantifiable SWMP Activity	Number of Activities Performed	Documentation / Record	Entity Performing the Activity	Comments
Part III.A.5	Municipal Waste Treatment, Storage, and Disposal Facilities Not Covered by an NPDES Stormwater Permit				
	Report the applicable facilities and the number of the inspections conducted for each facility.				
	Name of Facility	Number of Inspections			
	N/A	0			No municipal facilities
Part III.A.5 Summary	Provide an evaluation of the Stormwater Management Program according to Part VI.B.2 of the permit.				
	Strengths: No Waste TSD Facilities in the Town.				
	Limitations: N/A				
	SWMP revisions implemented to address limitations: N/A				
Part III.A.6	Pesticides, Herbicides, and Fertilizer Application				
	Report the number of permittee personnel applicators and contracted commercial applicators of pesticides and herbicides who are FDACS certified / licensed.				
	Report the number of permittee personnel who have been trained through the Green Industry BMP Program and the number of contracted commercial applicators of fertilizer who are FDACS certified / licensed.				
	PERSONNEL: FDACS public applicators of pesticides/herbicides	0			No pesticides, and herbicides applied by Town personnel; services privately contracted out
	CONTRACTORS: FDACS commercial applicators of pesticides/ herbicides	4	State Licenses	Total Property Control	FY 16/17 Log
	PERSONNEL: Green Industry BMP Program training completed	0			No fertilizers applied by Town personnel; services contracted out
	CONTRACTORS: FDACS certified / licensed applicators of fertilizer	4	State Licenses	Total Property Control	FY 16/17
	Provide a copy of the adopted ordinance with the Year 2 Annual Report. If this provision is not applicable because the permittee is not within the watershed of a nutrient-impaired water body, indicate that in Column F.				
	Year 2 ONLY: Attach copy of adopted Florida-friendly ordinance	0	Fertilizer Ordinance	Town Council	Adopted November, 2013

SECTION VII. STORMWATER MANAGEMENT PROGRAM (SWMP) SUMMARY TABLE					
A.	B.	C.	D.	E.	F.
Permit Citation/ SWMP Element	Permit Requirement/Quantifiable SWMP Activity	Number of Activities Performed	Documentation / Record	Entity Performing the Activity	Comments
	Report on the public education and outreach activities that are performed or sponsored by the permittee within the permittee's jurisdiction to encourage citizens to reduce their use of pesticides, herbicides and fertilizers including the type and number of activities conducted, the type and number of materials distributed, and the number of Web site visits (if applicable).				
	Brochures/Flyers/Fact sheets distributed	38	Brochures/ Flyers	Palm Beach County (PBC) Stormwater Systems Group; PBC Solid Waster Authority (PBCSWA); Florida Department of Environmental Protection (FDEP); Town Clerk	FY 16/17 Log
	Newspapers & newsletters: Number of articles/notices published	1	Newsletter/ Mailing List	Town Clerk	FY 16/17 Log
	Newsletters: Number of newsletters distributed	68	Property Owner Mailing List/Certification Letter	Town Clerk	FY 16/17 Log
	Public displays (e.g. kiosks, storyboards, posters, etc.)	1	Town Hall Display Rack	Town Clerk	
Part III.A.6 Summary	Provide an evaluation of the Stormwater Management Program according to Part VI.B.2 of the permit.				
	Strengths: Services are contracted out to a private contractor; Town has adopted a Fertilizer Ordinance; good public information system being implemented.				
	Limitations: None identified				
	SWMP revisions implemented to address limitations: None needed				
Part III.A.7.a	Illicit Discharges and Improper Disposal — Inspections, Ordinances, and Enforcement Measures				
	Report amendments in Year 4.				

SECTION VII. STORMWATER MANAGEMENT PROGRAM (SWMP) SUMMARY TABLE					
A.	B.	C.	D.	E.	F.
Permit Citation/ SWMP Element	Permit Requirement/Quantifiable SWMP Activity	Number of Activities Performed	Documentation / Record	Entity Performing the Activity	Comments
	Year 4 ONLY: Attach a report on amendments to applicable legal authority	N/A			
Part III.A.7.c	Illicit Discharges and Improper Disposal — Investigation of Suspected Illicit Discharges and/or Improper Disposal				
	Report on the proactive inspection program, including the number of inspections conducted by the permittee, the number of illicit activities found, and the number and type of enforcement actions taken.				
	Proactive inspections for suspected illicit discharges	1	(1) Proactive Discharge /Illegal Connection Inspection Form; (2) Monthly Inspection Checklist	(1) Doug Taylor/Code Enforcement Officer; Town Clerk	FY 16/17 Log; Annually Inspected; two (2) commercially zoned lots (currently vacant); no industrial lots; Proactive inspections are performed also as part of the Structural Control Inspections
	Inspections performed by Palm Beach County SQG Program	0			No inspections needed
	Illicit discharges found during a proactive inspection	0			None found
	NOV/WL/citation/fines issued for illicit discharges found during proactive inspection	0			None issued
	Report on the reactive investigation program as it relates to responding to reports of suspected illicit discharges, including the number of reports received, the number of investigations conducted, the number of illicit activities found, and the number and type of enforcement actions taken.				
	Reports of suspected illicit discharges received	0	(1) Reactive Discharge/ Illegal Connection Form; (2) Monthly Inspection Checklist	(1) Code Enforcement Officer; (2) Town Clerk	No reported illicit
	Reactive investigations of reports of suspected illicit discharges etc.	0			No investigations
	Illicit discharges etc. found during reactive investigation	0			None found
	NOV/WL/citation/fines issued for illicit discharges etc. found during reactive investigation	0			None issued

SECTION VII. STORMWATER MANAGEMENT PROGRAM (SWMP) SUMMARY TABLE					
A.	B.	C.	D.	E.	F.
Permit Citation/ SWMP Element	Permit Requirement/Quantifiable SWMP Activity	Number of Activities Performed	Documentation / Record	Entity Performing the Activity	Comments
	Report the type of training activities, and the number of permittee personnel and contractors trained (both in-house and outside training) within the reporting year.				
	Personnel trained	2	Illicit Discharge Detention and Elimination (IDDE) video	Town Clerk; Town Planning Consultant	
	Contractors trained	0			No contractors used for these purposes
Part III.A.7.d	Illicit Discharges and Improper Disposal — Spill Prevention and Response				
	Report on the spill prevention and response activities, including the number of spills addressed.				
	Hazardous and non-hazardous material spills responded to	0	PBC Fire Incident Report	PBC Fire Rescue Department	No spills reported during permit year
	Report the type of training activities, and the number of permittee personnel and contractors trained (both in-house and outside training) within the reporting year.				
	Personnel trained	2	Spills and Skills	Town Clerk; Town Planning Consultant	
	Contractors trained	0			No contractors used for these purposes
Part III.A.7.e	Illicit Discharges and Improper Disposal — Public Reporting				
	Report on the public education and outreach activities that are performed or sponsored by the permittee within the permittee's jurisdiction to encourage the public reporting of suspected illicit discharges and improper disposal of materials, including the type and number of activities conducted, the type and number of materials distributed, and the number of Web site visits (if applicable).				
	Brochures/Flyers/Fact sheets distributed	38	Brochures/ Flyers	PBC Stormwater Systems Group; PBCSWA; FDEP; Town Clerk	FY 16/17 Log
	Newspapers & newsletters: Number of articles/notices published	1	Newsletter Mailing List	Town Clerk	FY 16/17 Log
	Newsletters: Number of newsletters distributed	68	Property owner Mailing List/ certification Letter	Town Clerk	FY 16/17 Log
	Public displays (e.g. kiosks, storyboards, etc.)	1	Town Hall Display Rack	Town Clerk	

SECTION VII. STORMWATER MANAGEMENT PROGRAM (SWMP) SUMMARY TABLE					
A.	B.	C.	D.	E.	F.
Permit Citation/ SWMP Element	Permit Requirement/Quantifiable SWMP Activity	Number of Activities Performed	Documentation / Record	Entity Performing the Activity	Comments
Part III.A.7.f	Illicit Discharges and Improper Disposal — Oils, Toxics, and Household Hazardous Waste Control				
	Report on the public education and outreach activities that are performed or sponsored by the permittee within the permittee's jurisdiction to encourage the proper use and disposal of oils, toxics, and household hazardous waste, including the type and number of activities conducted, the type and number of materials distributed, the amount of waste collected / recycled / properly disposed, and the number of Web site visits (if applicable).				
	Brochures/Flyers/Fact sheets distributed	38	Brochures/ Flyers	PBC Systems Group; PBCSWA; FDEP; Town Clerk	FY 16/17 Log
	Newspapers & newsletters: Number of articles/notices published	1	Newsletter/ Mailing List	Town Clerk	FY 16/17 Log
	Newsletters: Number of newsletters distributed	68	Property owner Mailing List/Certification Letter	Town Clerk	FY 16/17 Log
	Public displays: 9e.g. kiosks, storyboards, etc.)	1	Town Hall Display Rack	Town Clerk	

SECTION VII. STORMWATER MANAGEMENT PROGRAM (SWMP) SUMMARY TABLE							
A.	B.			C.	D.	E.	F.
Permit Citation/ SWMP Element	Permit Requirement/Quantifiable SWMP Activity			Number of Activities Performed	Documentation / Record	Entity Performing the Activity	Comments
Part III.A.7.g	Illicit Discharges and Improper Disposal — Limitation of Sanitary Sewer Seepage						
	Report on the type and number of activities undertaken to reduce or eliminate SSOs and inflow/ infiltration, the number of SSOs or inflow / infiltration incidents found and the number resolved, and the name of the owner of the sanitary sewer system within the permittee's jurisdiction. Report only the SSOs and inflow / infiltration incidents into the MS4.						
	Owner of the sanitary sewer system			No central sanitary sewer system in the Town. (/)Individual property owners all have septic tank systems.			
	Activity to reduce/eliminate SSOs and I&I: (description)			0			Privately owned septic tank systems
				0			None discovered - Privately owned septic tank systems
				0			N/A
				0			None discovered
	SSO incidents discovered						
SSO incidents resolved							
Inflow / infiltration incidents discovered							
Inflow / infiltration incidents resolved			0			N/A	
Part III.A.7 Summary	For activities required by Part III.A.7: Provide an evaluation of the Stormwater Management Program according to Part VI.B.2 of the permit.						
	Strengths: No illicit discharges or improper disposal reported during current permit year; Town Clerk and Consultant have been trained; good public information being implemented.						
	Limitations: None identified						
	SWMP Revisions implemented to address limitations: None needed at this time.						
Part III.A.8.a	Industrial and High-Risk Runoff — Identification of Priorities and Procedures for Inspections						
	Report on the high-risk facilities inventory, including the type and total number of high risk facilities and the number of facilities newly added each year.						
	Report on the high-risk facilities inspection program, including the number of inspections conducted and the number and type of enforcement actions taken.						
	Type of Facility	Number of Facilities	Number of Inspections	Enforcement Actions			
	Operating municipal landfills	0					No landfills in Town
	Hazardous waste treatment, storage, disposal and recovery (HWTSDR) facilities	0					No hazardous waste facilities

SECTION VII. STORMWATER MANAGEMENT PROGRAM (SWMP) SUMMARY TABLE								
A.	B.			C.		D.	E.	F.
Permit Citation/ SWMP Element	Permit Requirement/Quantifiable SWMP Activity			Number of Activities Performed		Documentation / Record	Entity Performing the Activity	Comments
	EPCRA Title III, Section 313 facilities (TRI)		0					No EPCRA facilities
	Facilities determined as high risk by the permittee		0					No high risk facilities
Part III.A.8.b	Industrial and High-Risk Runoff — Monitoring for High Risk Industries							
	Report the number of high risk facilities sampled.							
	High risk facilities sampled		0				N/A	
Part III.A.8 Summary	Provide an evaluation of the Stormwater Management Program according to Part VI.B.2 of the permit.							
	Strengths: No high risk facilities in Town.							
	Limitations: N/A							
	SWMP revisions implemented to address limitations: N/A							
Part III.A.9.a	Construction Site Runoff — Site Planning and Non-Structural and Structural Best Management Practices							
	Report the number of permittee and private pre-construction site plans reviewed for stormwater, erosion, and sedimentation controls, and the number approved.							
	PERMITTEE SITES: Construction site plans reviewed			0		Site Plan Review Procedures established in the SWMP; notations on construction plans and/or Construction Plan Report, if required	Town Clerk; Town Planning Consultant; Town Engineer; Building Official	No construction site plans reviewed during permit year
	PERMITTEE SITES: Construction site plans approved			0				N/A
	PRIVATE SITES: Construction site plans reviewed			0		Site Plan Review Procedures established in the SWMP; notations on construction plans and/or Construction Plan Report, if required		
	PRIVATE SITES: Construction site plans approved			0				N/A
	Report the number of development permit applicants notified of the ERP and CGP, and the number of applicants who confirmed ERP and CGP coverage.							

SECTION VII. STORMWATER MANAGEMENT PROGRAM (SWMP) SUMMARY TABLE						
A.	B.		C.	D.	E.	F.
Permit Citation/ SWMP Element	Permit Requirement/Quantifiable SWMP Activity		Number of Activities Performed	Documentation / Record	Entity Performing the Activity	Comments
	Notified of ERP stormwater permit requirements		0			No new development or redevelopment applied for during permit year
	Confirmed ERP coverage		0			N/A
	Notified of CGP stormwater permit requirements		0			N/A
	Confirmed CGP coverage		0			N/A
Part III.A.9.b	Construction Site Runoff — Inspection and Enforcement					
	Report on the inspection program for privately-operated and permittee-operated construction sites, including the number of active construction sites during the reporting year, the number of inspections of active construction sites, the percentage of active construction sites inspected, and the number and type of enforcement actions / referrals taken.					
	PERMITTEE SITES: Active construction sites		0			No new permittee construction during permit year
	PERMITTEE SITES: Pre-, During, and Post inspections of active construction sites for E&S and waste control BMPs		0			N/A
	PERMITTEE SITES: Percentage of active construction sites inspected		0			N/A
	PRIVATE SITES: Active construction sites		0			No new private construction during permit year
	PRIVATE SITES: Pre-, During, and Post inspections of active construction sites for E&S and waste control BMPs		0			N/A
	PRIVATE SITES: Percentage of active construction sites inspected		0			N/A
	Enforcement Action		0			N/A
Part III.A.9.c	Construction Site Runoff — Site Operator Training					
	Report the type of training activities, the number of inspectors, site plan reviewers and site operators trained (both in-house and outside training).					
		DEP Certification	Annual Training			
	Permittee construction site inspectors	0	2	Ground Control video	Town Clerk; Town Planning Consultant	
	Permittee construction site plan reviewers		0		Cheryl Moore/State Certified Trainer	

SECTION VII. STORMWATER MANAGEMENT PROGRAM (SWMP) SUMMARY TABLE					
A.	B.	C.	D.	E.	F.
Permit Citation/ SWMP Element	Permit Requirement/Quantifiable SWMP Activity	Number of Activities Performed	Documentation / Record	Entity Performing the Activity	Comments
	Permittee construction site operators	0			Contracted out
Part III.A.9 Summary	Provide an evaluation of the Stormwater Management Program according to Part VI.B.2 of the permit.				
	Strengths: No new construction during permit year.				
	Limitations: N/A				
	SWMP revisions implemented to address limitations: N/A				

SECTION VIII. CHANGES TO THE STORMWATER MANAGEMENT PROGRAM (SWMP) ACTIVITIES (Not Applicable in Year 4)		
A.	Permit Citation/ SWMP Element	Proposed Changes to the Stormwater Management Program Activities Established as Specific Requirements Under Part III.A of the Permit (Including the Rationale for the Change) — REQUIRES DEP APPROVAL PRIOR TO CHANGE IF PROPOSING TO REPLACE OR DELETE AN ACTIVITY.
	N/A	
B.	Permit Citation/ SWMP Element	Changes to the Stormwater Management Program Activities NOT Established as Specific Requirements Under Part III.A of the Permit (Including the Rationale for the Change)
	N/A	

SECTION IX. TMDL Status Report

A.	YEAR 1 Provide a table summarizing the status of the TMDL process. Include a list of prioritized TMDLs and their monitoring and implementation schedule; and include the Identification number of the outfall prioritized for TMDL monitoring.								
	WBID Number	Segment/ Waterbody/ Basin	Pollutant of Concern	TMDL DEP / EPA	Percent Reduction (WLA)	Priority Rank	Priority Outfall	Monitoring Summary / BPCP Due Date	Supplemental SWMP Due Date
	N/A			<input type="checkbox"/> / <input type="checkbox"/>		1		(Year 3 AR)	(Year 4 AR; N/A) if BPCP)
				<input type="checkbox"/> / <input type="checkbox"/>					
B.	YEAR 3 and annually thereafter, provide a summary of the estimated load reductions that have occurred for the pollutant(s) of concern being discharged from the MS4 to the TMDL water body during the reporting period and cumulatively since the date the Supplemental SWMP was implemented. Year 3: Submit a Monitoring data summary or BPCP (if applicable). Year 4: Submit a Supplemental SWMP (if applicable).								
	WBID Number	Pollutant of Concern	Monitoring Summary / BPCP Submitted	Supplemental SWMP Submitted	Projected load reductions OR Actual load reductions to date				
	N/A		(Year 3 AR)	(Year 4 AR; N/A if BPCP)					
C.	Provide a brief statement as to the status of TMDL implementation according to Part VIII.B of the permit (e.g. status of monitoring to validate WLA): <i>No discharge to a TMDL WBID at the time of permit issuance.</i>								

Attachment 2

Town of Cloud Lake

"STORMWATER/DRAINAGE SYSTEM MAP"

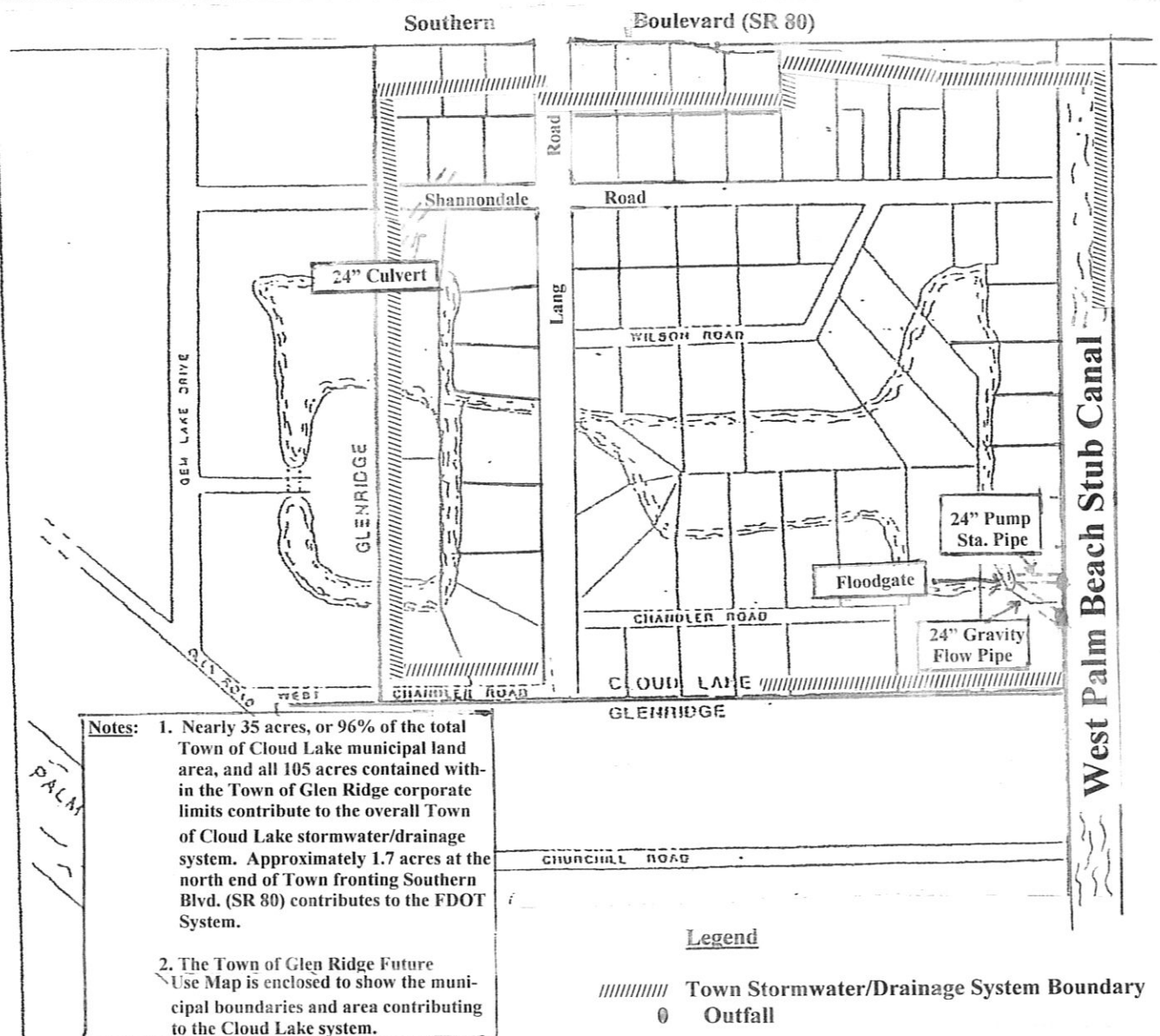

ASSOCIATES

2010

Part of Attachment 2
 ("Town of Cloud Lake Stormwater/Drainage System Map")

Local Streets

1. Taylor
2. Churchill
3. Chandler
4. Shannondale
5. Gem Lake
6. Windham
7. Glen Road
8. Island Road

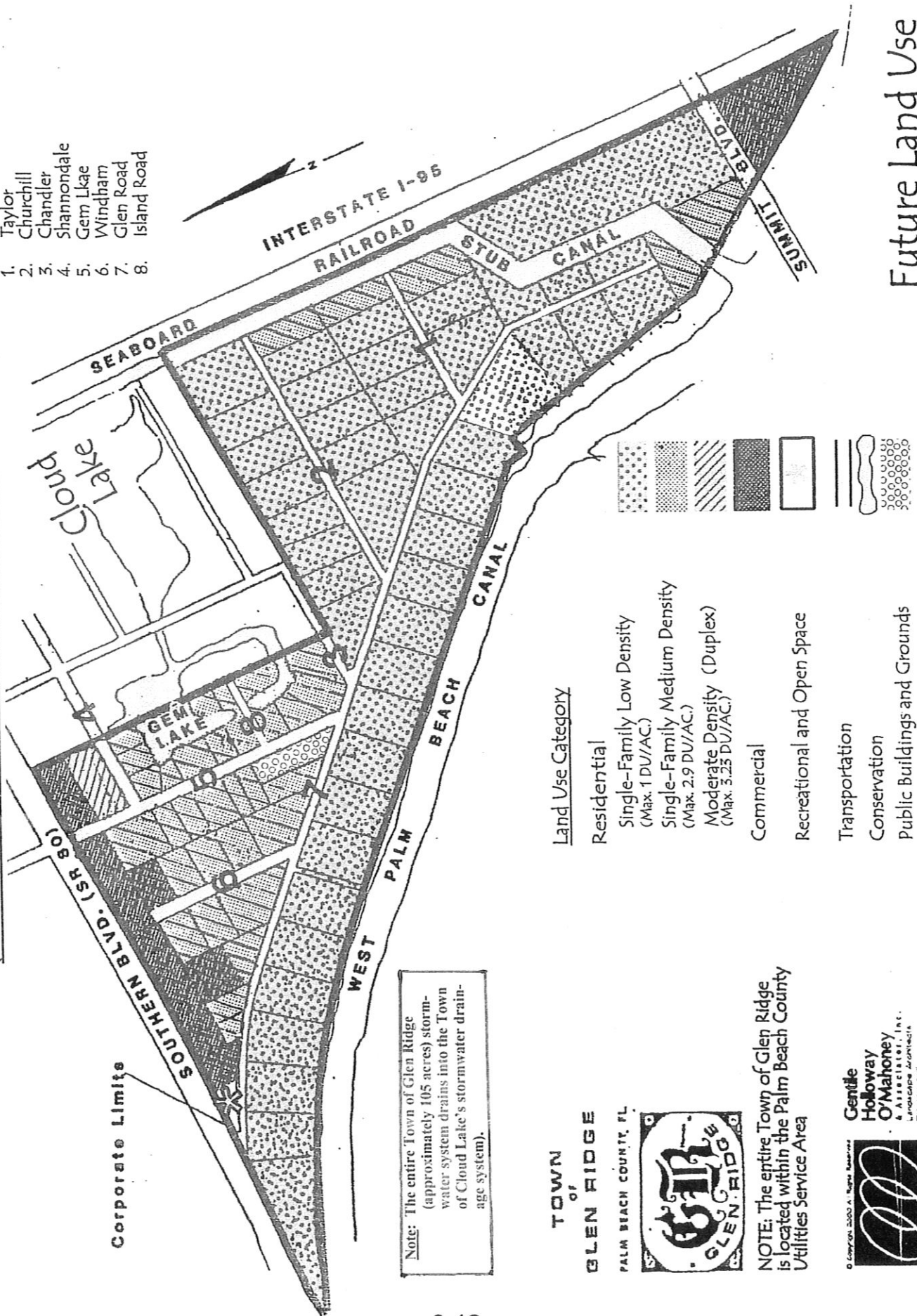

Future Land Use
 FY- 2012/2013 - 2017/2018

Figure 3-4